

THIS DRAWING IS UNPUBLISHED.

RELEASED FOR PUBLICATION

REVISIONS

© COPYRIGHT - TE Connectivity Ltd.

ALL RIGHTS RESERVED.

P	LTR	DESCRIPTION	DATE	DWN	APVD
	A	INITIAL DRAWING	24AUG2019	VM	MP

### Ordering Information

Sample Part Number **▶**

Series: **K47 A 3 3 4**

Contact Form: **A = SPST-NO B = SPST-NC**

Coil Voltage: **2 = 12 Vdc, Bus Wire 3 = 26.5 Vdc, Bus Wire**

High Voltage Connections: **3 = Solder Connection**

Mounting: **2 = Flanged 4 = Standard**

### Product Specifications for K47A and K47B

<b>Contact Arrangement</b> — K47A — SPST-NO K47B — SPST-NC	<b>Contact Capacitance</b> — Between Open Contacts — 1.2 pF Open Contacts to Ground — 1.2 pF
<b>Contact Form</b> — K47A — A K47B — B	<b>Contact Resistance, Max.</b> — 0.03 ohm
<b>Test Voltage, DC or 60 Hz (Peak)</b> — 9 kV	<b>Operate Time, Max.</b> — 10 ms
<b>Rated Operating Voltage (Peak)</b> — DC or 60 Hz — 8 kV 2.5 MHz — 7.5 kV 16 MHz — 7 kV 32 MHz — 5 kV	<b>Release Time, Max.</b> — 10 ms
<b>Continuous Carry Current, Max.</b> — DC or 60 Hz — 12 A 2.5 MHz — 10 A 16 MHz — 5 A	<b>Shock, 11ms, 1/2 Sine (Peak)</b> — 30 g
<b>Coil Data</b>	<b>Vibration</b> — Peak — 10 g (55 to 1000 Hz)
<b>Nominal Volts DC</b> — 12 Vdc / 26.5 Vdc	<b>Operating Ambient Temperature Range</b> — -55°C to +125°C
<b>Pickup, Max.</b> — 8 Vdc / 16 Vdc	<b>Mechanical Life</b> — 2 million cycles
<b>Dropout</b> — .5-5 Vdc / 1-10 Vdc	<b>Weight, Nominal</b> — 25.5 g (0.9 oz.)
<b>Coil Resistance (±10%)</b> — 230 Ω / 707 Ω	

Nominal Volts DC	12 Vdc	26.5 Vdc
Pickup, Max.	8 Vdc	16 Vdc
Dropout	.5-5 Vdc	1-10 Vdc
Coil Resistance (±10%)	230 Ω	707 Ω

Ratings listed are for 25°C, sea level conditions

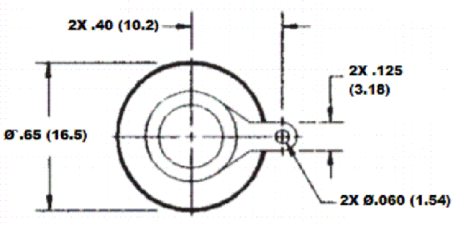
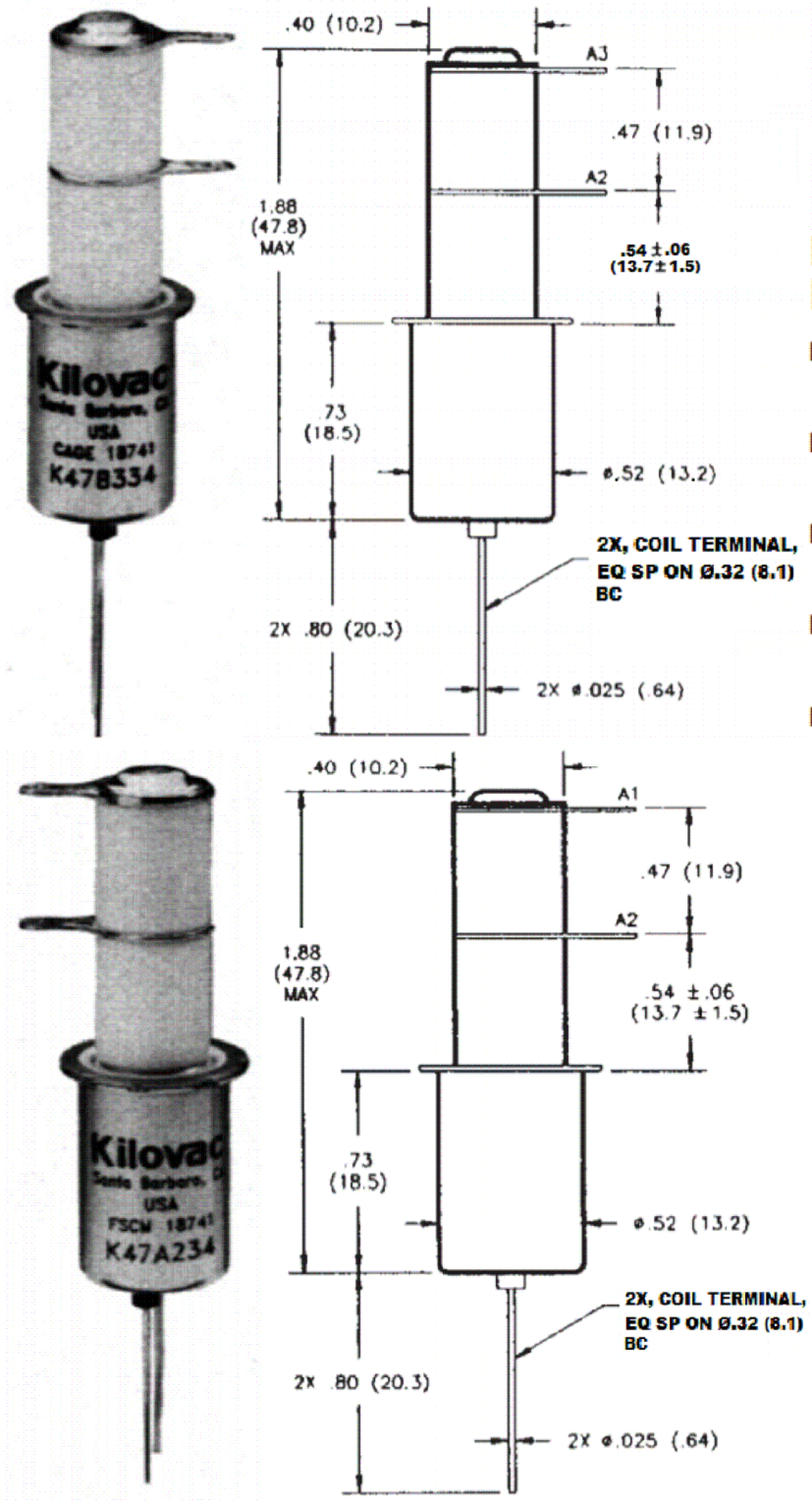

### K47B Product Facts for K47B

- Normally closed version of K47
- Vacuum dielectric for power switching low current loads
- 707 Ohm coil for low power consumption
- Meets requirements of MIL-R-83725
- QPL version available, M83725/18-003

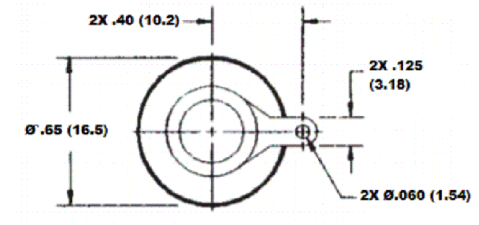

### K47A Product Facts for K47A

- Widely used in antenna coupler applications
- Short actuator, low profile, 8 kV relay
- Vacuum dielectric for power switching low current loads
- Normally open contacts
- Meets requirements of MIL-R-83725

ALL DIMENSIONS ARE IN INCHES(MM)

THIS DRAWING IS A CONTROLLED DOCUMENT.		DWN VM 24AUG2019	TE Connectivity		
		CHK RV 24AUG2019			
DIMENSIONS: INCHES		APVD MP 24AUG2019	NAME K47 SERIES MAKE AND BREAK LOAD SWITCHING		
TOLERANCES UNLESS OTHERWISE SPECIFIED:		PRODUCT SPEC	SIZE A3		
0 PLC ± -		APPLICATION SPEC	CAGE CODE -		
1 PLC ± -		WEIGHT 0	DRAWING NO C-K47-SERIES		
2 PLC ± -		MATERIAL -	RESTRICTED TO -		
3 PLC ± -			SCALE NTS		
4 PLC ± -		SHEET 1 OF 1			
ANGLES ± -		REV A			
FINISH -		CUSTOMER DRAWING			