

THIS DRAWING IS UNPUBLISHED.  
 © Copyright 2022 TE Connectivity Ltd.  
 RELEASED FOR PUBLICATION  
 ALL RIGHTS RESERVED.

REV.	ECR#	ZONE	DESCRIPTION	CHANGED BY/DATE	APPROVED BY/DATE
F01	ECN-IAS-04202		INITIAL RELEASE	WT NG 15JUN15	HANG 15JUN15

REVISIONS

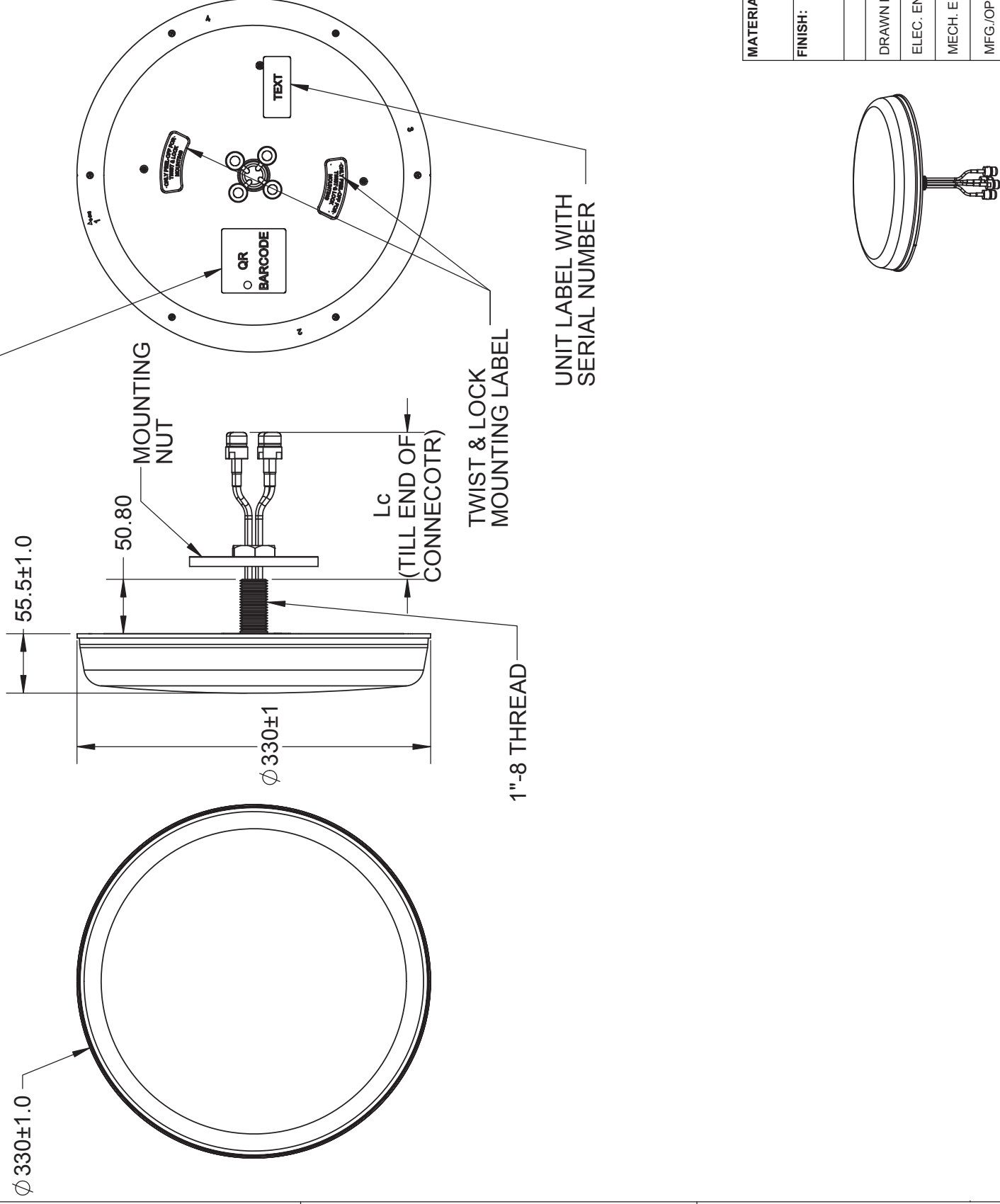

PARAMETER	SPECIFICATION						
Frequency Bands, MHz	698-806	824-894	880-960	1710-1880	1850-1990	2300-2500	2500-2700
Peak Gain, dBi (Typ)	3.6	3.8	3.7	5.4	5.0	4.7	4.5
Peak Gain, dBi (Max)	5.4	4.7	4.2	6.0	5.4	5.4	5.1
VSWR (Typ)	<1.8:1	<1.6:1	<1.7:1	<1.6:1	<1.6:1	<1.8:1	<1.7:1
VSWR (Max)	<2.0:1	<2.0:1	<2.0:1	<2.0:1	<2.0:1	<2.0:1	<2.0:1
Isolation, dB (Max)	<-15	<-15	<-15	<-17	<-17	<-17	<-17
Port 1->Port 2, dB (Typ)	<-15	<-19	<-20	<-24	<-27	<-23	<-23
Port 1->Port 3, dB (Typ)	<-17	<-17	<-19	<-18	<-22	<-24	<-26
Port 1->Port 4, dB (Typ)	<-15	<-17	<-18	<-24	<-28	<-22	<-23
Port 2->Port 3, dB (Typ)	<-15	<-18	<-18	<-24	<-29	<-22	<-23
Port 2->Port 4, dB (Typ)	<-17	<-18	<-19	<-19	<-22	<-23	<-27
Port 3->Port 4, dB (Typ)	<-15	<-17	<-18	<-24	<-27	<-23	<-24
PIM, 3rd Order, 2 x 20W (Typ)	<-154 dBc						<-164 dBc
PIM, 3rd Order, 2 x 20W (Max)	<-153 dBc						
Nominal Impedance	-50 Ω						
Max Power (ambient temp of 25°C)	50 Watts						
Polarization	Linear, Omni-directional						
Radome	PC / ABS, UV stable						
Conenctor Type	DIN 4.3-10, Female						
Exposed Cable Length	300±15mm						
Mounting	Ceiling mount (drywall or tile flush mount )						
Dimensions (diameter x height)	330 mm x 55.5 mm (12.9" x 2.2")						
Weight	Approximately 1.18 kg (2.6 lbs.)						
Storage Temperature (°C)	-40° C to +85° C ( -40° F to 185° F)						
Operational Temperature (°C)	-30° C to +70° C ( -22° F to 158° F)						
Flammability Rating (Radome)	UL 94V0 Materials						
Material Substance Compliance	RoHS Compliant						

<b>MATERIAL:</b>		THIRD ANGLE PROJECTION		TITLE:	
<b>FINISH:</b>		DO NOT SCALE DRAWING		CMQ69273P-30D43F	
APPROVALS		DATE		REV	
DRAWN BY	WT NG	12JUN15		F01	
ELEC. ENG.	TY NG	12JUN15		REV	
MECH. ENG.	WT NG	12JUN15		F01	
MFG./OPS.	CH FONG	12JUN15		REV	
				F01	
				REV	
				F01	
				REV	
				F01	

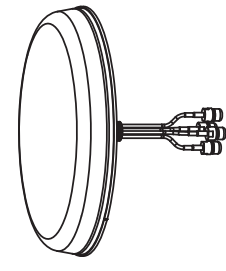

# PRIMARY MOUNTING OPTION:

## STUD MOUNTING

THIS DRAWING IS UNPUBLISHED.

RELEASED FOR PUBLICATION

© Copyright 2022 TE Connectivity Ltd.

ALL RIGHTS RESERVED.

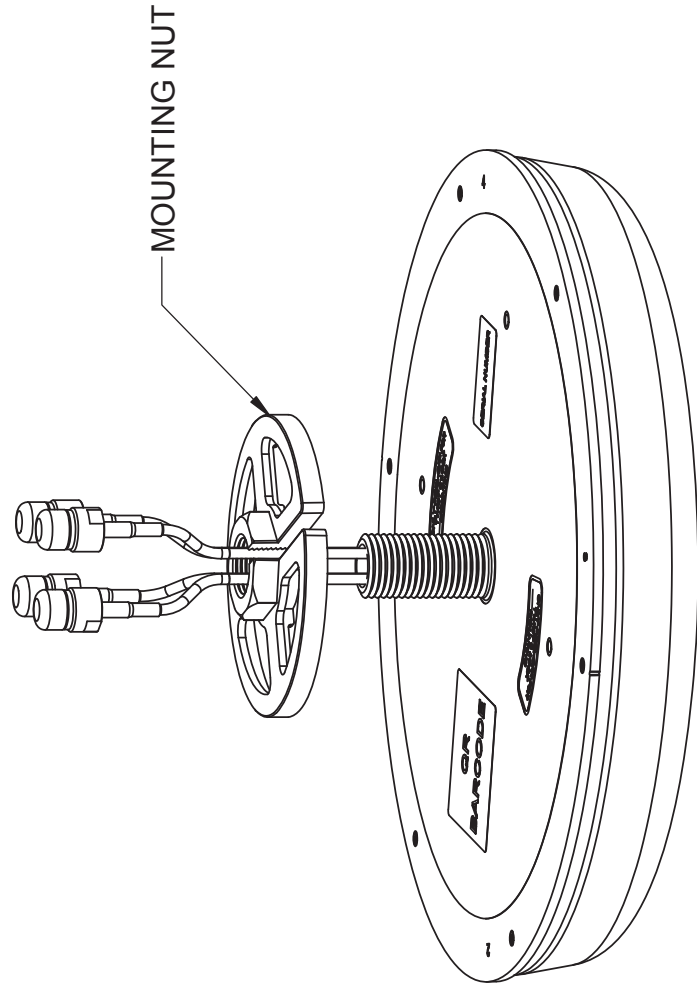

MOUNTING NUT

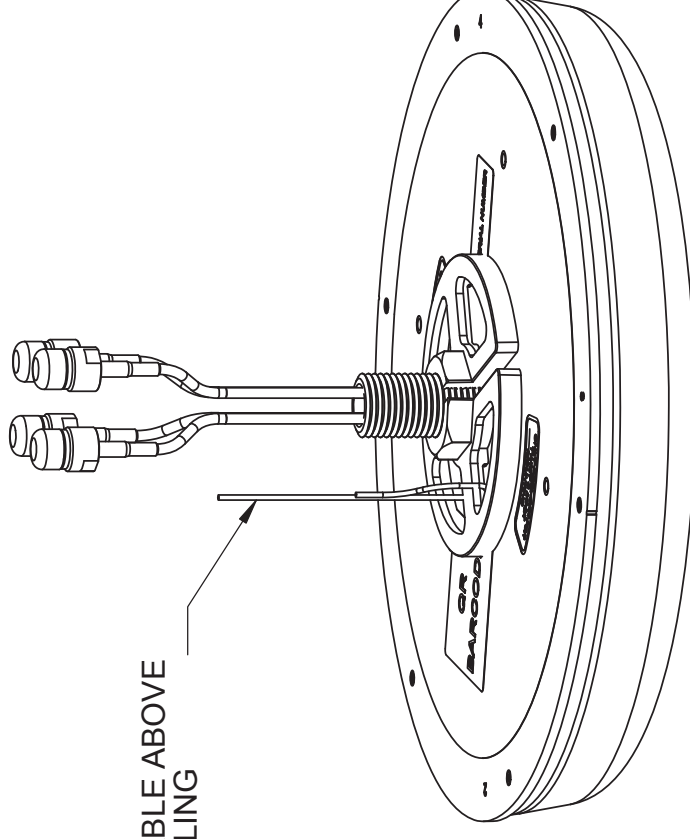

SUPPORTING CABLE ABOVE  
SUSPENDED CEILING  
(NOT SUPPLIED)

A

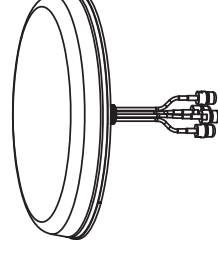

SIZE	DWG. NO	REV
A3	CMQ69273P-30D43FMO	F01
SCALE: 1:5 PREVIOUS#		SHEET 2 OF 6

NOTE: THE MOUNTING KIT (172-00051) IS INCLUDED WITH THE ANTENNA.

# SECONDARY MOUNTING OPTION:

## TWIST & LOCK MOUNTING ON DRYWALL / SHEETROCK

Part Number: HKIT-CMx-003

THIS DRAWING IS UNPUBLISHED.  
© Copyright 2022 TE Connectivity Ltd.

RELEASED FOR PUBLICATION  
ALL RIGHTS RESERVED.

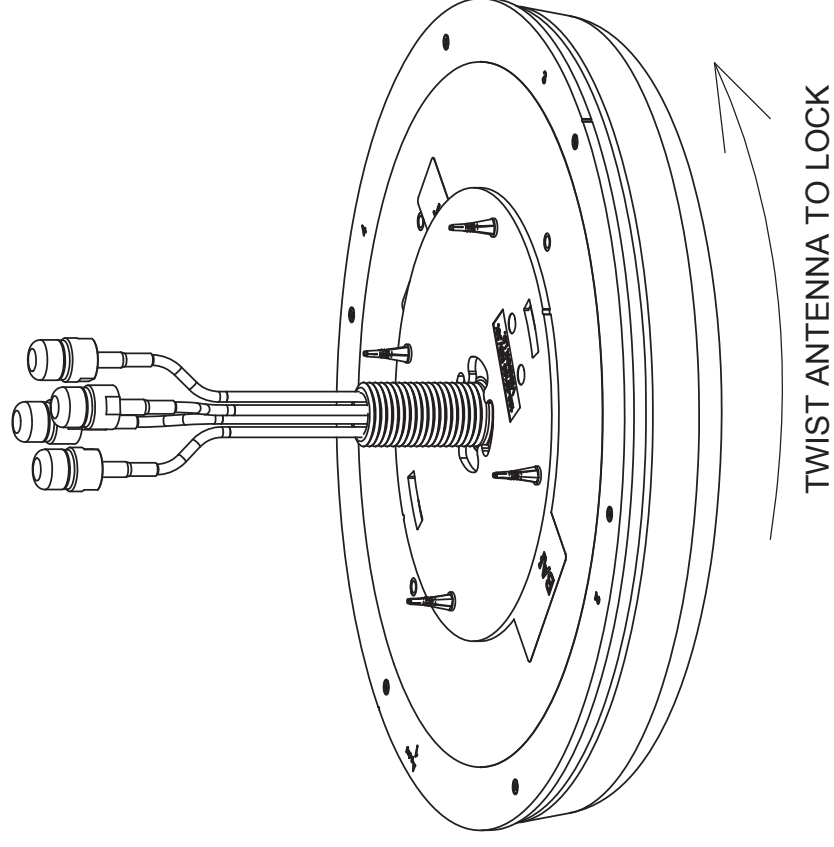
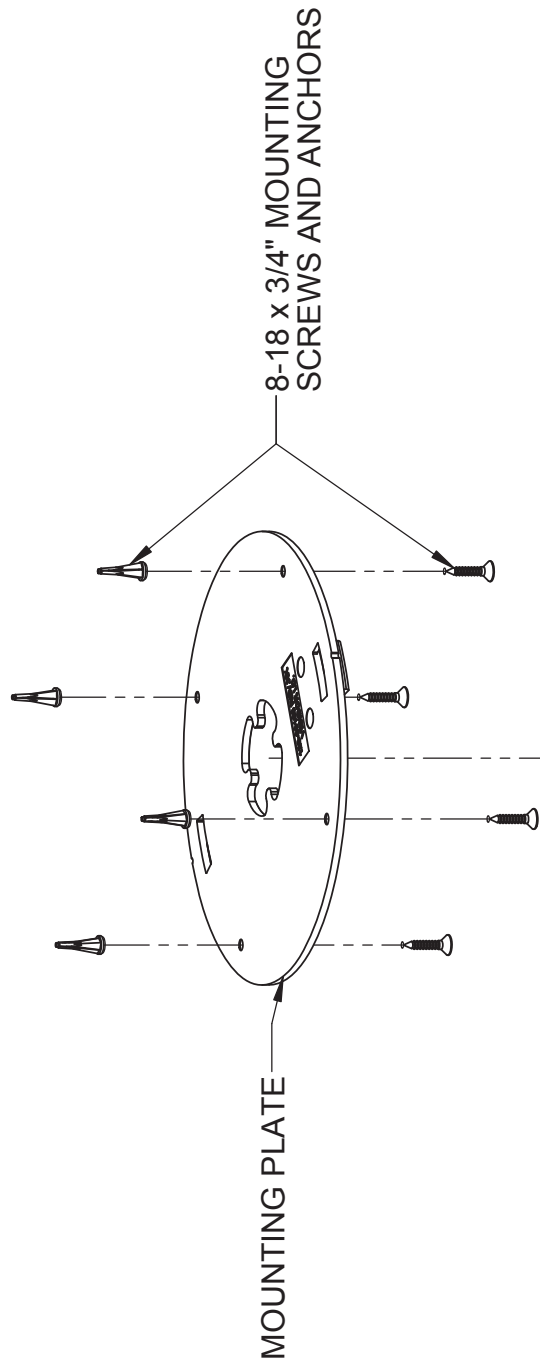

INSERT THE HOOK OF MOUNTING PLATE INTO THE HOLES ON BASE PLATE AND TWIST CLOCKWISE TO LOCK.

NOTE: The mounting kit (HKIT-CMx-003) is **NOT INCLUDED** with the antenna; it needs to be purchased separately.

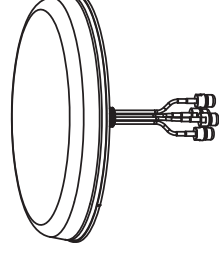

SIZE	DWG. NO	REV
A3	CMQ69273P-30D43FMO	F01
SCALE: 1:5	PREVIOUS#	SHEET 3 OF 6

**ABOVE CEILING MOUNTING:**  
**PE FOAM STANDOFF (DOUBLE SIDED ADHESIVE)**  
**Part Number: HKIT-CMx-004**

THIS DRAWING IS UNPUBLISHED.  
 © Copyright 2022 TE Connectivity Ltd.

RELEASED FOR PUBLICATION  
 ALL RIGHTS RESERVED.

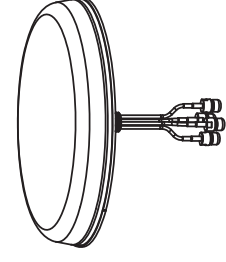
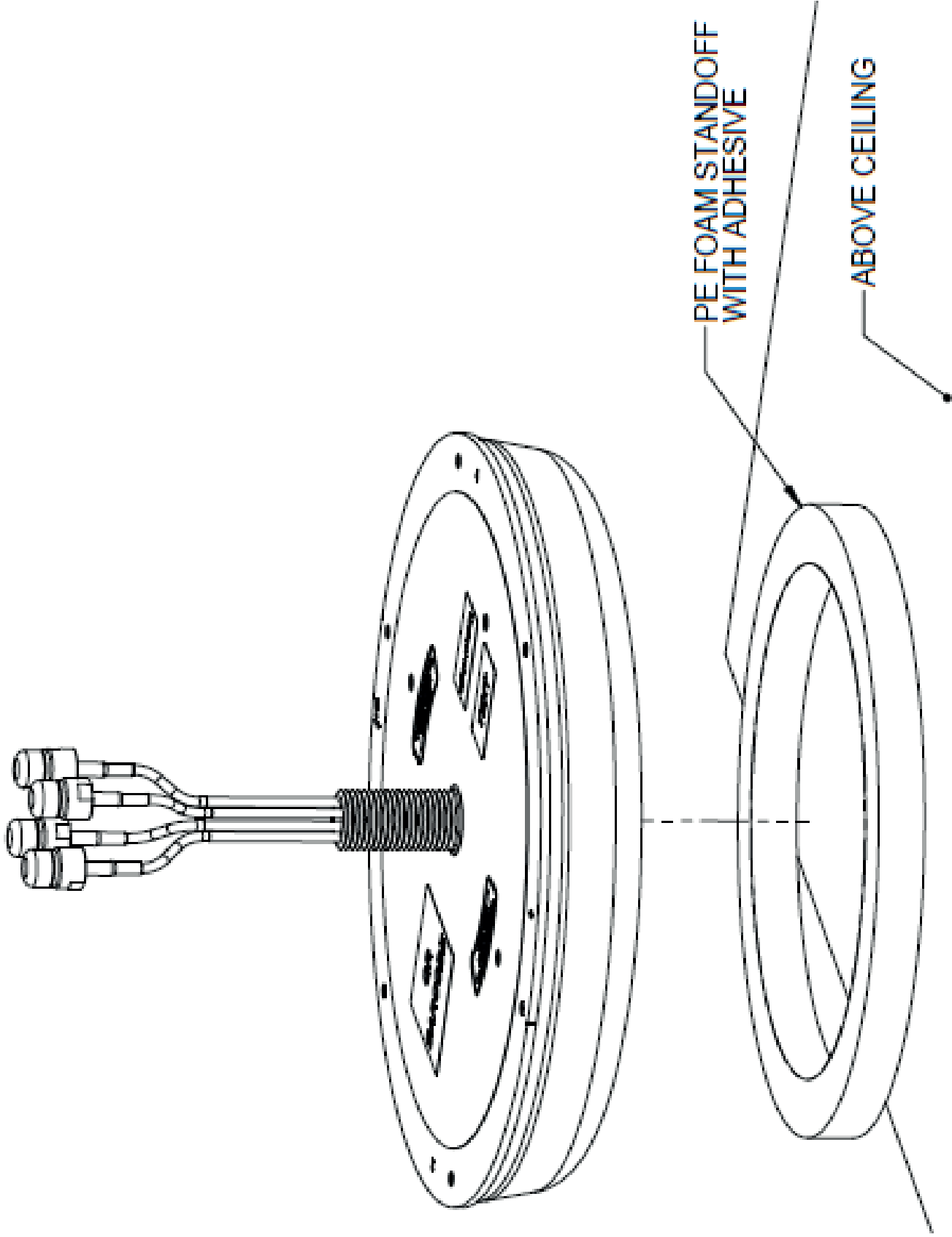

NOTE: The mounting kit (HKIT-CMx-004) is **NOT INCLUDED** with the antenna; it needs to be purchased separately.



SIZE	DWG. NO	REV
<b>A3</b>	<b>CMQ69273P-30D43FMO</b>	<b>F01</b>
SCALE: 1:5 PREVIOUS#		SHEET 4 OF 6

# ABOVE CEILING MOUNTING: MOUNTING BRACKET Part Number: HKIT-CMx-001

THIS DRAWING IS UNPUBLISHED.

RELEASED FOR PUBLICATION

© Copyright 2022 TE Connectivity Ltd.

ALL RIGHTS RESERVED.

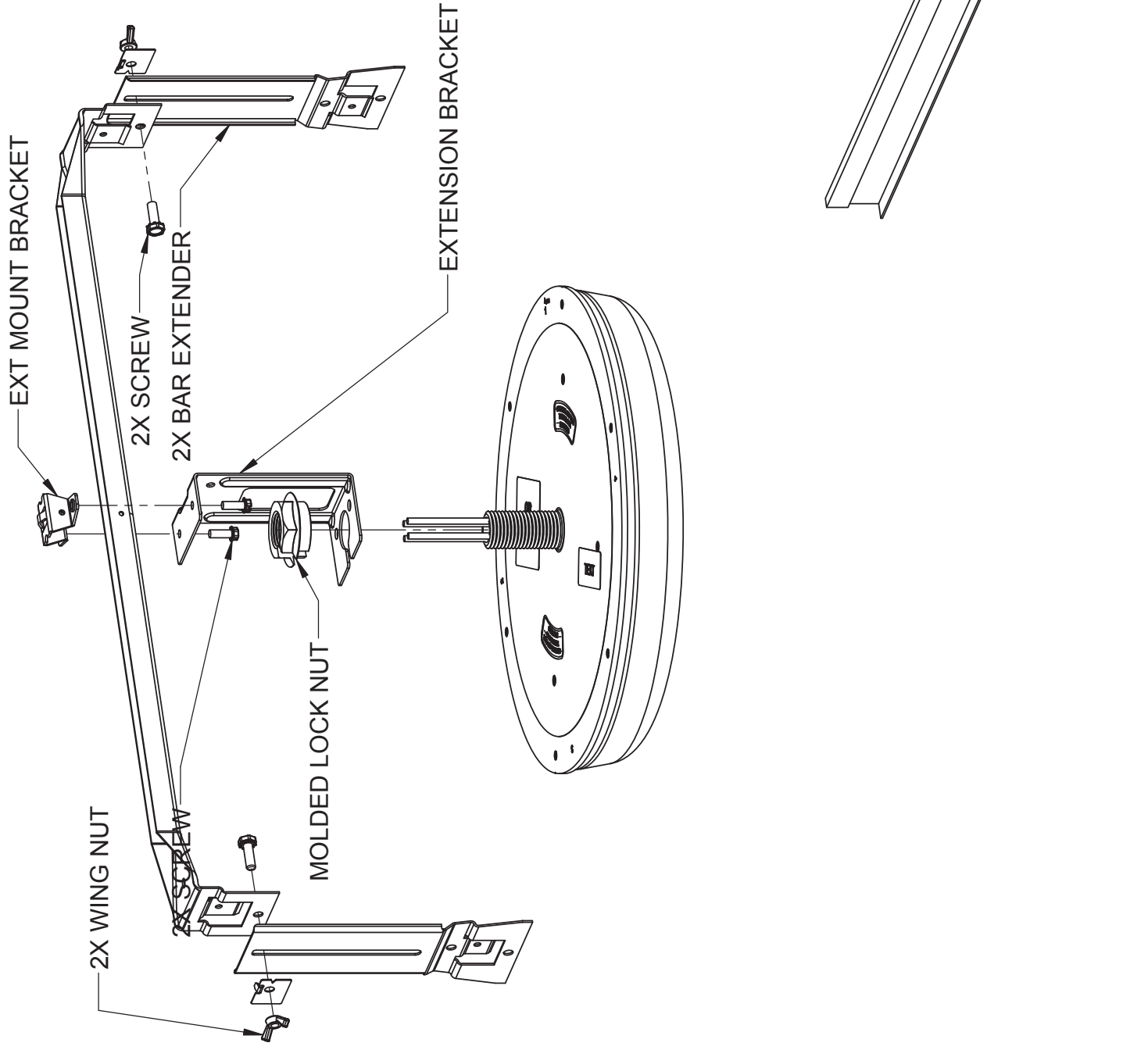

SIZE	DWG. NO	REV
<b>A3</b>	<b>CMQ69273P-30D43FMO</b>	<b>F01</b>
SCALE: 1:5		PREVIOUS#
		SHEET 5 OF 6

NOTE: The mounting kit (HKIT-CMx-001) is **NOT INCLUDED** with the antenna; it needs to be purchased separately.

# HARD CEILING MOUNTING: Part Number: HKIT-CMx-002

THIS DRAWING IS UNPUBLISHED.

RELEASED FOR PUBLICATION

© Copyright 2022 TE Connectivity Ltd.

ALL RIGHTS RESERVED.

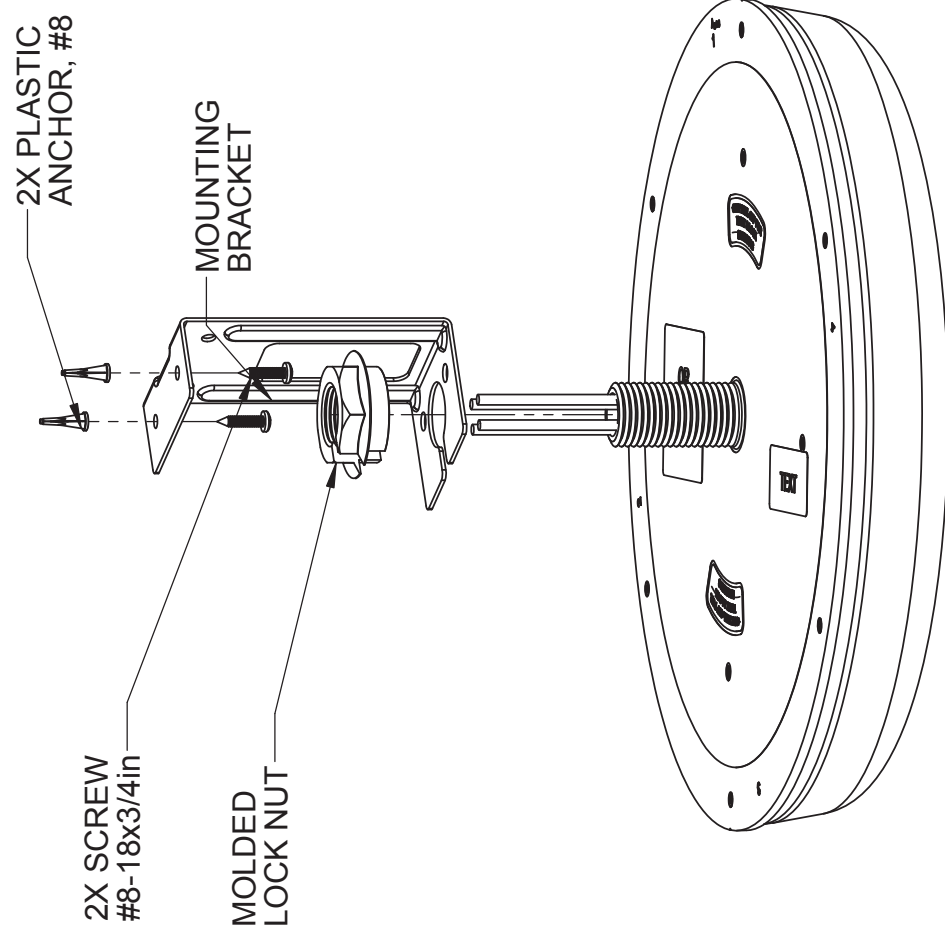

TOP MOUNTING

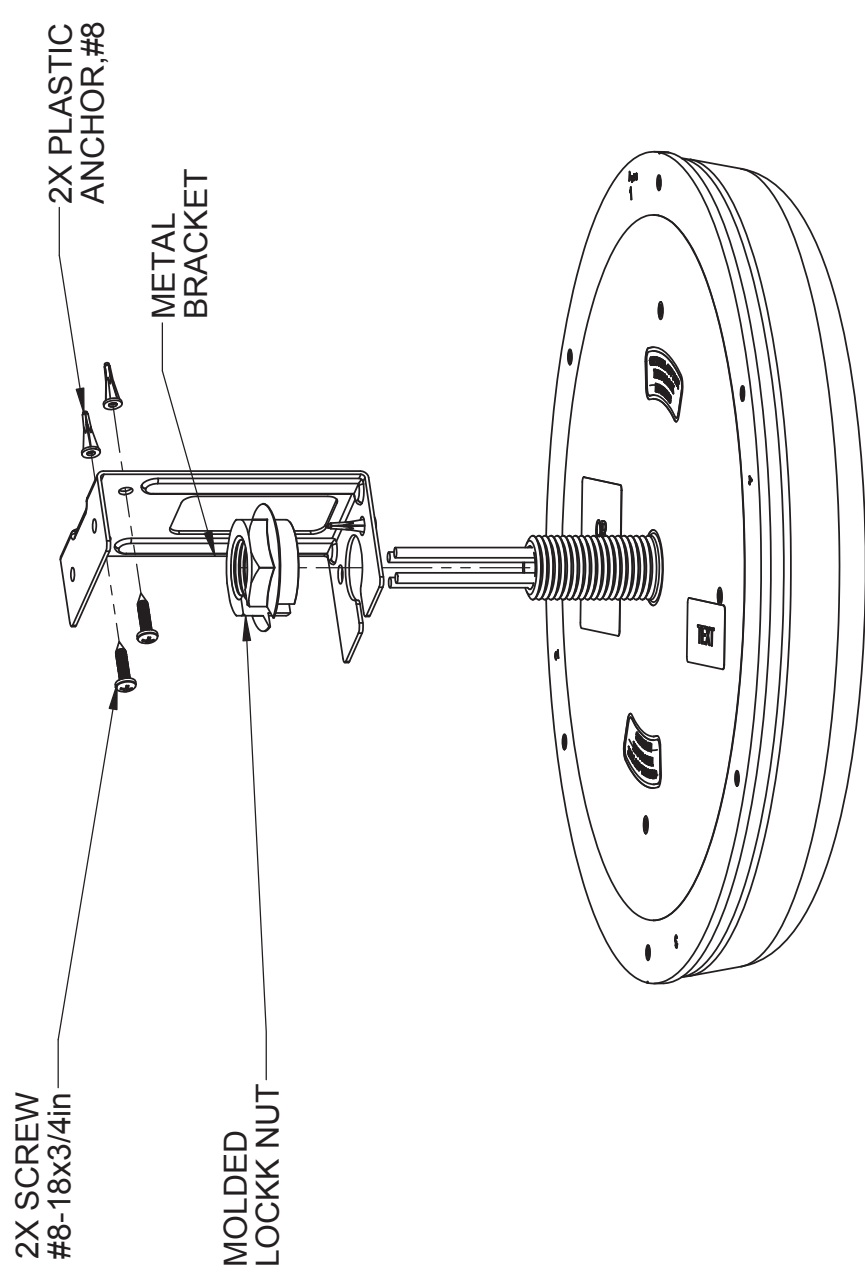

SIDE MOUNTING



SIZE	DWG. NO	REV
<b>A3</b>	<b>CMQ69273P-30D43FMO</b>	<b>F01</b>

SCALE: 1:5 PREVIOUS# SHEET 6 OF 6