

| LOC |     | DIST                  |         | REVISIONS |      |  |  |
|-----|-----|-----------------------|---------|-----------|------|--|--|
| P   | LTN | DESCRIPTION           | DATE    | DMN       | APVD |  |  |
| G   |     | REV PER ECO 15-010033 | 7-10-15 | CT        | DH   |  |  |

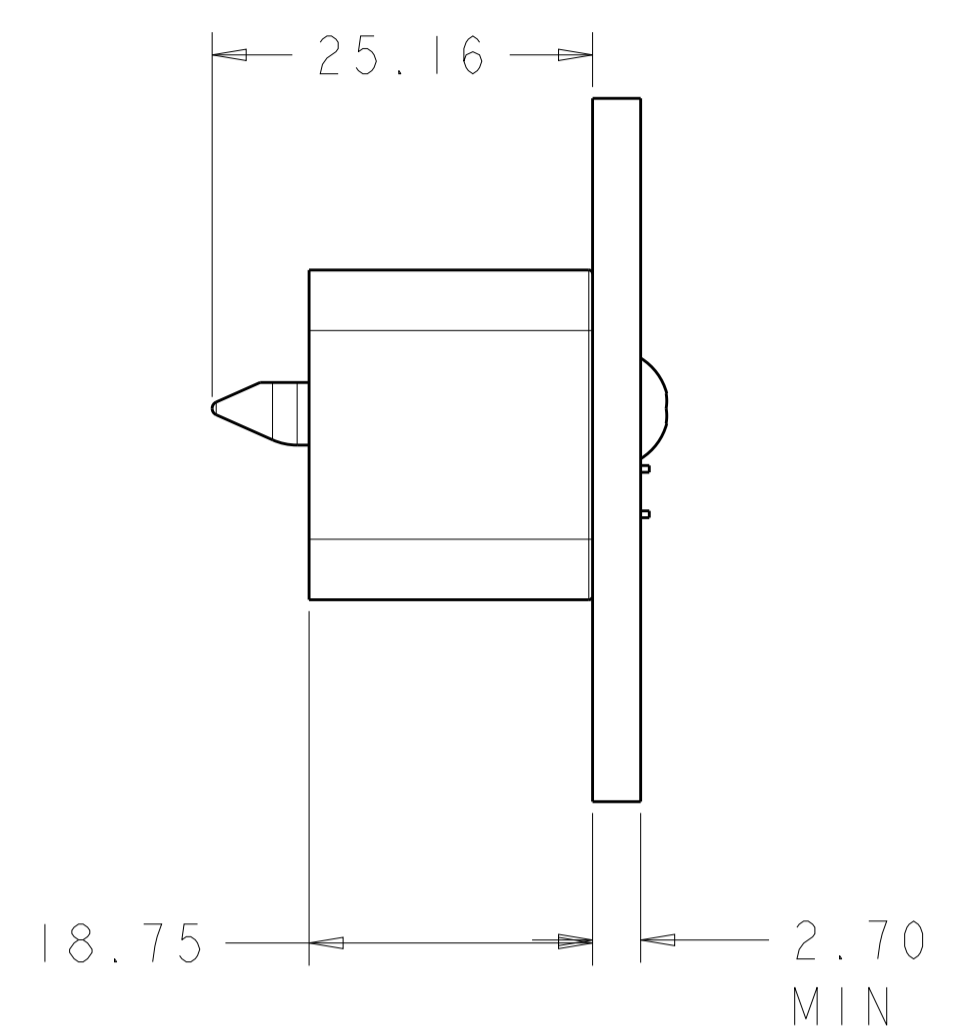

- MATING CONNECTOR FOR THIS CONNECTOR IS 2000979.
- MATERIAL- SHELL: ALUMINUM  
HOUSING: GLASS FILLED POLYESTER, UL94VO  
RETAINING RING: STAINLESS STEEL  
KEYING GUIDE PIN: STAINLESS STEEL
- PLATING- SHELL: ELECTROLESS NICKEL
- KEYING GUIDE PIN PACKAGED FOR ASSEMBLY BY CUSTOMER.
- PLATING- CONTACT MATING AREA:  
1.27µm MIN GOLD OVER 1.27µm MIN NICKEL  
CONTACT PCB AREA: 0.5µm MIN TIN OVER 1.27µm MIN NICKEL

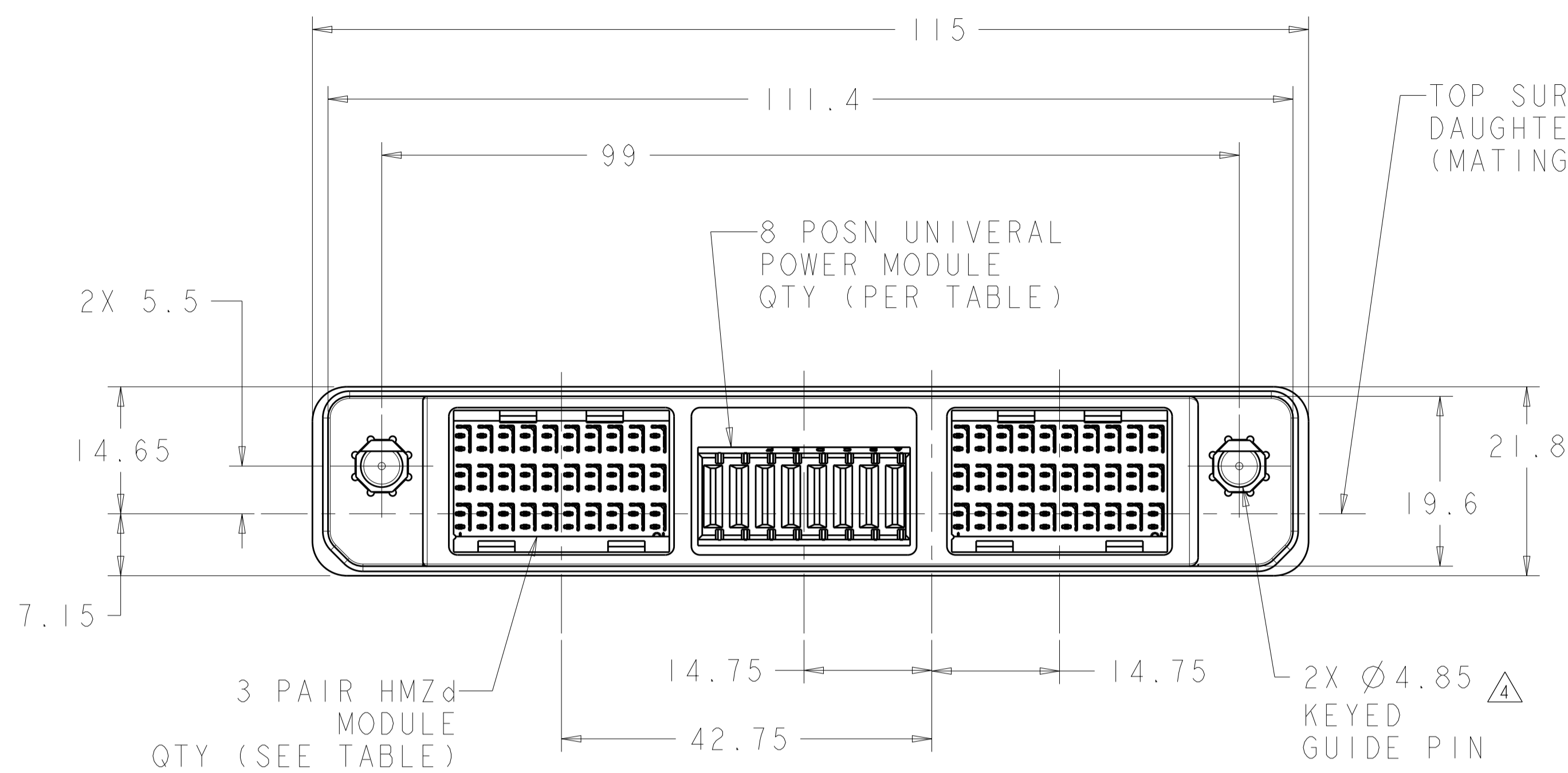
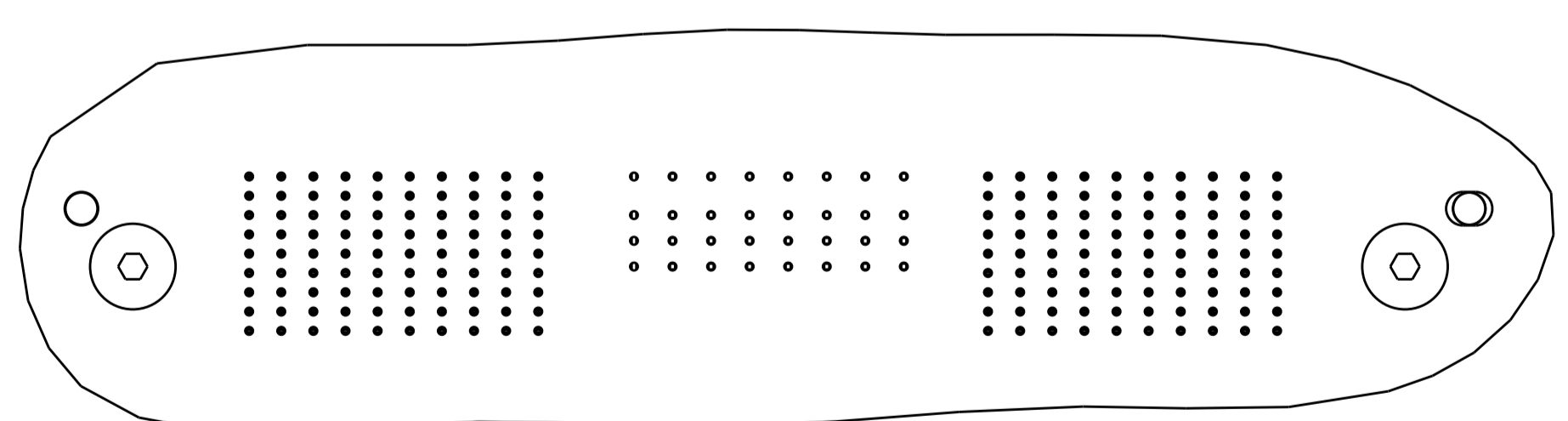
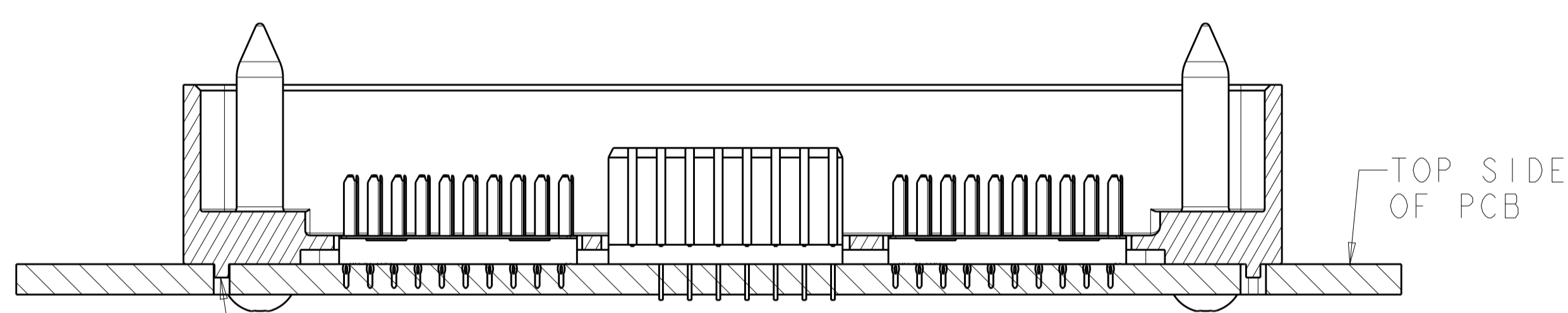

OBSOLETE  
 NOT RELEASED FOR PRODUCTION

|                             |                           |                   |                       |                    |             |
|-----------------------------|---------------------------|-------------------|-----------------------|--------------------|-------------|
|                             | 2                         | 1                 | --                    | --                 | 5-2000980-4 |
| OBSOLETE                    | 2                         | 1                 | --                    | --                 | 5-2000980-3 |
| NOT RELEASED FOR PRODUCTION | --                        | 1                 | 1                     | 1                  | 2000980-6   |
|                             | --                        | -                 | -                     | 3                  | 2000980-5   |
|                             | --                        | 1                 | -                     | 2                  | 2000980-4   |
| OBSOLETE                    | --                        | 1                 | -                     | 2                  | 2000980-3   |
| OBSOLETE                    | --                        | 1                 | 1                     | 1                  | 2000980-2   |
| OBSOLETE                    | --                        | -                 | -                     | 3                  | 2000980-1   |
|                             | 3 PAIR HMZd MODULE (RoHS) | 8 POSN UPM MODULE | 7 POSN RF COAX MODULE | 3 PAIR HMZd MODULE | PART NUMBER |
| MODULE QTY PER ASSY         |                           |                   |                       |                    |             |

THIS DRAWING IS A CONTROLLED DOCUMENT. DWN: Brent D. Tolm 13JAN2010  
 CHK: CHONG YI 13JAN2010  
 APVD: M. R. McALONIS 13JAN2010

STC TE Connectivity

NAME: MOTHER BOARD CONNECTOR, HIGH SPEED RUGGEDIZED (HSR), 3 BAY, UNSEALED, VERTICAL

PRODUCT SPEC: 108-2381  
 APPLICATION SPEC: -

SIZE: A1 CAGE CODE: 00779 DRAWING NO: 2000980 RESTRICTED TO: -

MATERIAL: - FINISH: - WEIGHT: -  
 CUSTOMER DRAWING SCALE: 2:1 SHEET 1 OF 3 REV G

| LOC | DIST | REV | DATE      | BY              | APPV |
|-----|------|-----|-----------|-----------------|------|
| -   | -    | 1   | 13JAN2010 | Brent D. Tolpin |      |
| -   | -    | 2   | 13JAN2010 | CHONG YI        |      |
| -   | -    | 3   | 13JAN2010 | M. R. McALONIS  |      |

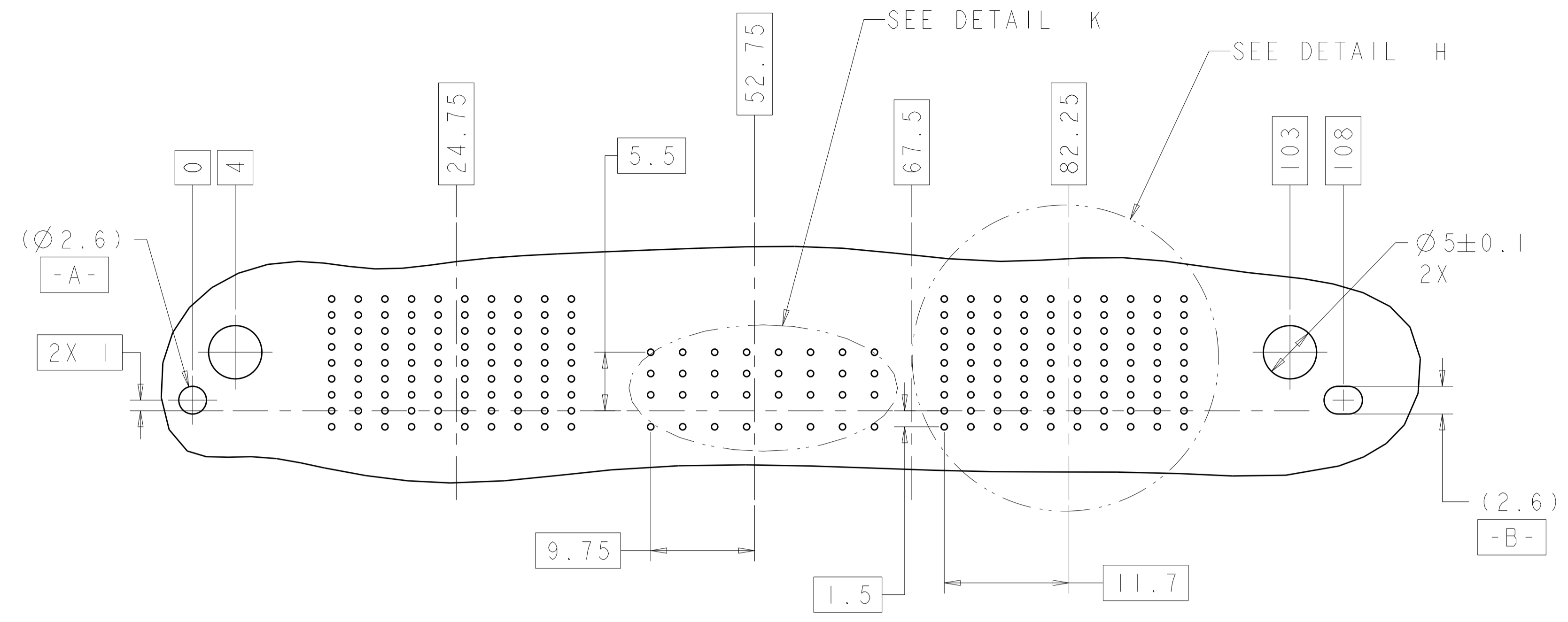

RECOMMENDED PC BOARD HOLE LAYOUT  
AS VIEWED FROM TOP OF PCB  
PCB FOR 2000980-4 SHOWN  
(2 HM-Zd AND 1 UPM MODULE)  
SCALE 3:1

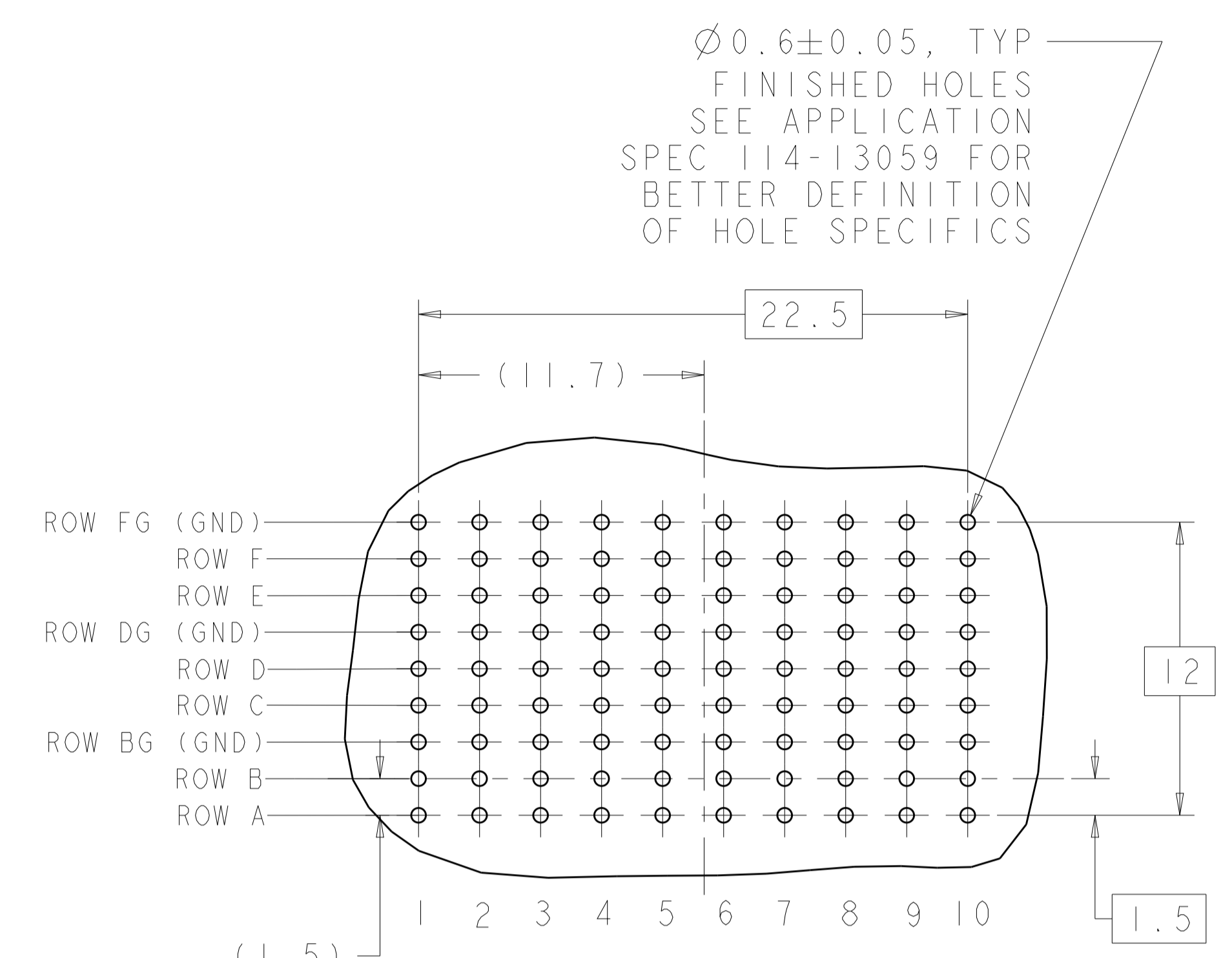

3 PAIR HMZd  
TYP 2X FOR -4  
TYP 3X FOR -5  
DETAIL H  
SCALE 5:1

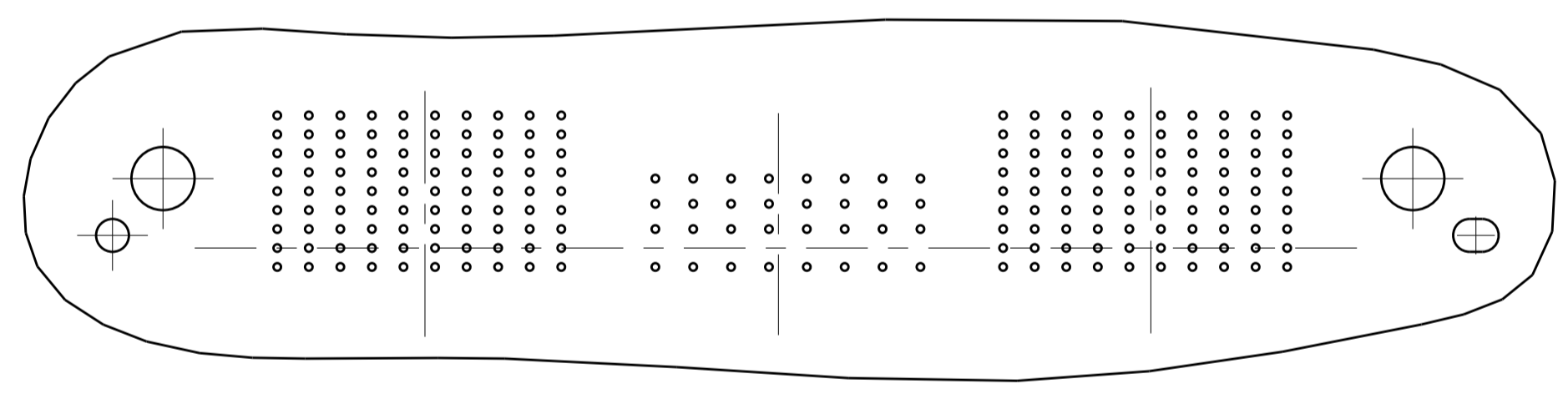

POCKET C POCKET B POCKET A  
2000980-4 PCB  
SCALE 2:1

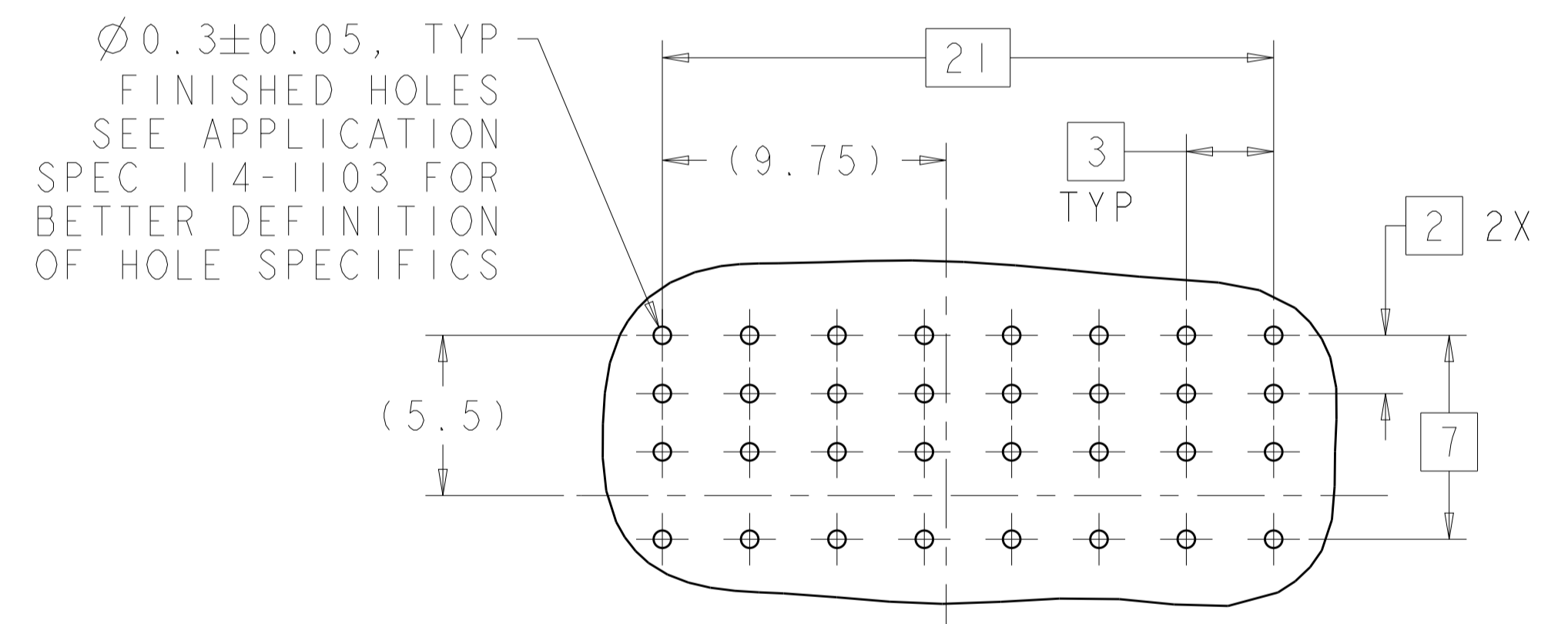

H G F E D C B A  
8 POSITION  
UNIVERSAL POWER MODULE  
DETAIL K  
SCALE 5:1

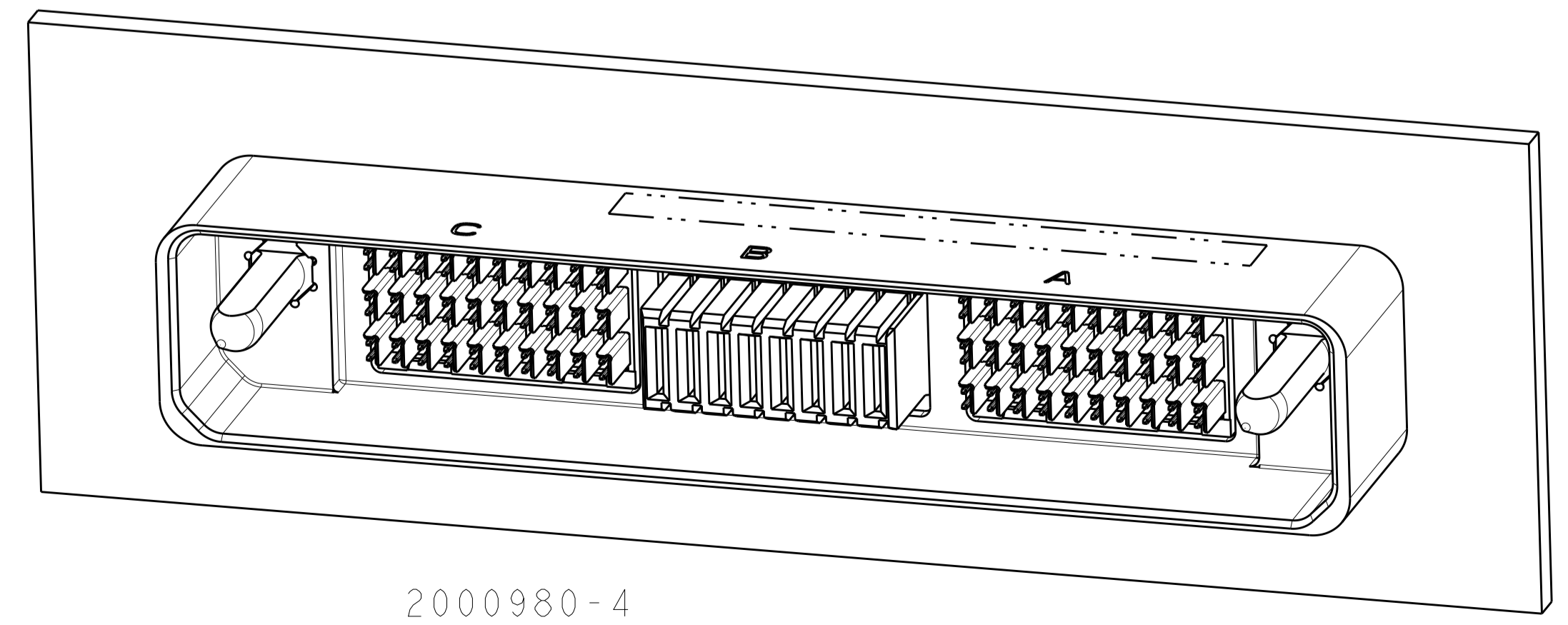

2000980-4  
SCALE 2:1

|  |  |                      |           |   |
|--|--|----------------------|-----------|---|
| THIS DRAWING IS A CONTROLLED DOCUMENT.   |  | OWN: Brent D. Tolpin | 13JAN2010 | TE Connectivity   |
| DIMENSIONS: mm   |  | CHK: CHONG YI        | 13JAN2010 |   |
| TOLERANCES UNLESS OTHERWISE SPECIFIED:   |  | APVD: M. R. McALONIS | 13JAN2010 | NAME: MOTHER BOARD CONNECTOR, HIGH SPEED RUGGEDIZED (HSR), 3 BAY, UNSEALED, VERTICAL<br>PRODUCT SPEC: 108-2381<br>APPLICATION SPEC: |
| 0 PLC ±0.2<br>1 PLC ±0.1<br>2 PLC ±0.05<br>3 PLC ±0.025<br>4 PLC ±0.1<br>ANGLES ±° |  | FINISH: SEE TABLE    | WEIGHT: - |   |
| MATERIAL: -  |  | SCALE: 1:1           |           | RESTRICTED TO: -  |
| CUSTOMER DRAWING   |  | A100779 ©=2000980    |           | SHEET 2 OF 3  |

| LOC |   | DIST |   | REVISIONS   |      |     |      |
|-----|---|------|---|-------------|------|-----|------|
|     |   |      |   | DESCRIPTION | DATE | DMN | APVD |
| -   | - | -    | - | SEE SHEET 1 | -    | -   | -    |
|     |   |      |   |             |      |     |      |
|     |   |      |   |             |      |     |      |

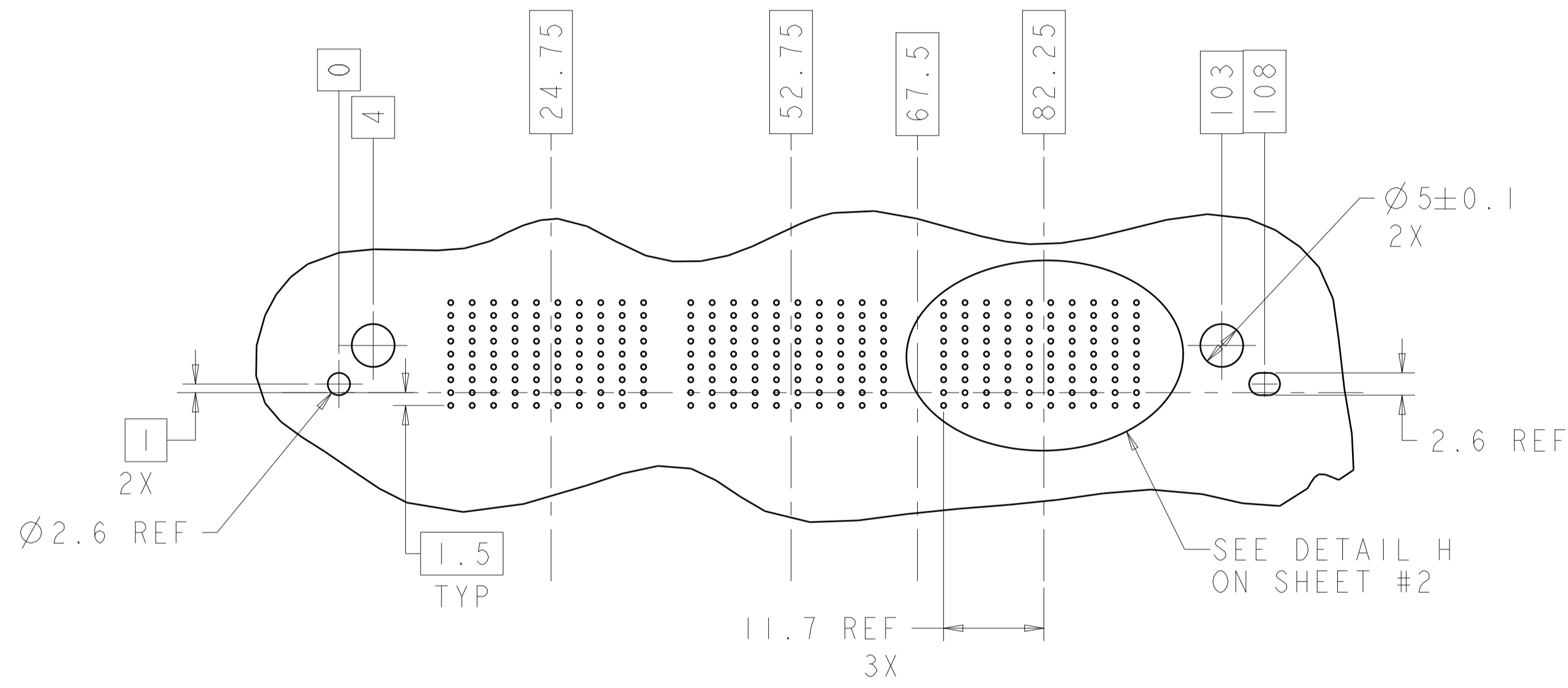

RECOMMENED PC BOARD LAYOUT (MOTHERBOARD)  
 FOR 2000980-5  
 AS VIEWED FROM TOP OF PCB  
 (3 HM-Zd)

|   |        |                                     |  |          |      |       |       |       |        |       |   |                          |                 |  |
|---|--------|-------------------------------------|--|----------|------|-------|-------|-------|--------|-------|---|--------------------------|-----------------|--|
| THIS DRAWING IS A CONTROLLED DOCUMENT.  |        | DMN<br>Brent D. Togni<br>13JAN2010  | TE Connectivity  |          |      |       |       |       |        |       |   |                          |                 |  |
| DIMENSIONS:<br>mm   |        | CHK<br>CHONG YI<br>13JAN2010        |  |          |      |       |       |       |        |       |   |                          |                 |  |
| TOLERANCES UNLESS OTHERWISE SPECIFIED:  |        | APVD<br>M. R. McALONIS<br>13JAN2010 | NAME<br>MOTHER BOARD CONNECTOR,<br>HIGH SPEED RUGGEDIZED (HSR),<br>3 BAY, UNSEALED, VERTICAL |          |      |       |       |       |        |       |   |                          |                 |  |
| <table border="1"> <tr> <td>0 PLC</td> <td>±0.2</td> </tr> <tr> <td>1 PLC</td> <td>±0.1</td> </tr> <tr> <td>2 PLC</td> <td>±0.05</td> </tr> <tr> <td>3 PLC</td> <td>±0.025</td> </tr> <tr> <td>4 PLC</td> <td>±</td> </tr> </table> |        | 0 PLC                               | ±0.2   | 1 PLC    | ±0.1 | 2 PLC | ±0.05 | 3 PLC | ±0.025 | 4 PLC | ± | PRODUCT SPEC<br>108-2381 | SIZE<br>A100779 |  |
| 0 PLC   | ±0.2   |                                     |  |          |      |       |       |       |        |       |   |                          |                 |  |
| 1 PLC   | ±0.1   |                                     |  |          |      |       |       |       |        |       |   |                          |                 |  |
| 2 PLC   | ±0.05  |                                     |  |          |      |       |       |       |        |       |   |                          |                 |  |
| 3 PLC   | ±0.025 |                                     |  |          |      |       |       |       |        |       |   |                          |                 |  |
| 4 PLC   | ±      |                                     |  |          |      |       |       |       |        |       |   |                          |                 |  |
| ANGLES<br>FINISH<br>SEE TABLE   |        | APPLICATION SPEC                    | DRAWING NO<br>C=2000980  |          |      |       |       |       |        |       |   |                          |                 |  |
| MATERIAL<br>-   |        | WEIGHT<br>-                         | RESTRICTED TO<br>-   |          |      |       |       |       |        |       |   |                          |                 |  |
| CUSTOMER DRAWING  |        | SCALE<br>1:1                        | SHEET<br>3 OF 3  |          |      |       |       |       |        |       |   |                          |                 |  |
|   |        |                                     |  | REV<br>G |      |       |       |       |        |       |   |                          |                 |  |