

| REVISIONS | | | | |
|-----------|-----|---------------------------|-----------|--------|
| P | LTN | DESCRIPTION | DATE | APVD |
| B | | REVISED PER ECO-19-011736 | 06AUG2019 | AP JW |
| C | | REVISED PER ECO-19-013357 | 29AUG2019 | CJV JW |
| E | | REVISED PER ECO-20-014352 | 12OCT2020 | TX DZ |
| E1 | | REVISED PER ECN-23-213603 | 19MAY2023 | JG DZ |

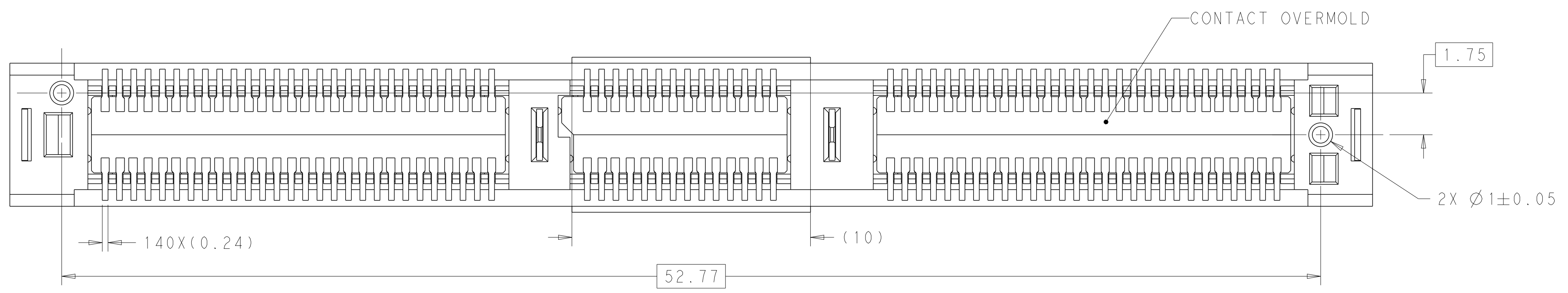

- 1 HOUSING AND CONTACT OVERMOLDS - LCP, UL94-V0, BLACK. CONTACTS AND HOLD DOWNS - COPPER ALLOY. PICK AND PLACE TAPE - POLYIMIDE FILM.
- 2 CONTACTS - GOLD PLATE ON MATING SURFACES, TIN PLATE ON SOLDER FEET. HOLD DOWNS - TIN PLATE.
- 3 DATUMS AND BASIC DIMENSIONS ESTABLISHED BY CUSTOMER.
- 4. MINIMUM HOST PCB THICKNESS: 1.5.
- 5 SEE MSA SPECIFICATION FOR ADDITIONAL PADDLE CARD LAYOUTS COMPATIBLE WITH THIS RECEPTACLE AND FOR OPTIONAL SPLIT CONTACT PAD LAYOUTS FOR THE PADDLE CARD. SPECIFICATION PINOUT MAY ALSO DESIGNATE PAD SEQUENCE DIFFERENT FROM ILLUSTRATION.
- 6 POSITIONS DESIGNATED AS "SIGNAL" ARE REQUIRED LOCATIONS FOR HIGH SPEED DIFFERENTIAL PAIR SIGNALING. THESE LOCATIONS MAY ALSO BE USED FOR SUPPORTING SIDEBAND SIGNALS OR OTHER UTILITY PURPOSES. POSITIONS DESIGNATED AS "GROUND" ARE REQUIRED WHEN SUPPORTING HIGH SPEED DIFFERENTIAL SIGNALS. THESE LOCATIONS MAY ALSO BE USED FOR SIDEBAND SIGNALS OR OTHER UTILITY PURPOSES.
- 7 COMPONENT AND TRACE KEEP OUT AREA. EACH EDGE 0.15 MIN FROM EDGE OF HOLE.
- 8 TAPE AND REEL PACKAGED FOR PICK AND PLACE SMT PROCESSING, SEE FIGURE 1. POCKET TAPE WIDTH = 72.
- 9 MATES WITH BOARDS DESIGNED TO THE SFF-TA-1002 SPECIFICATION.

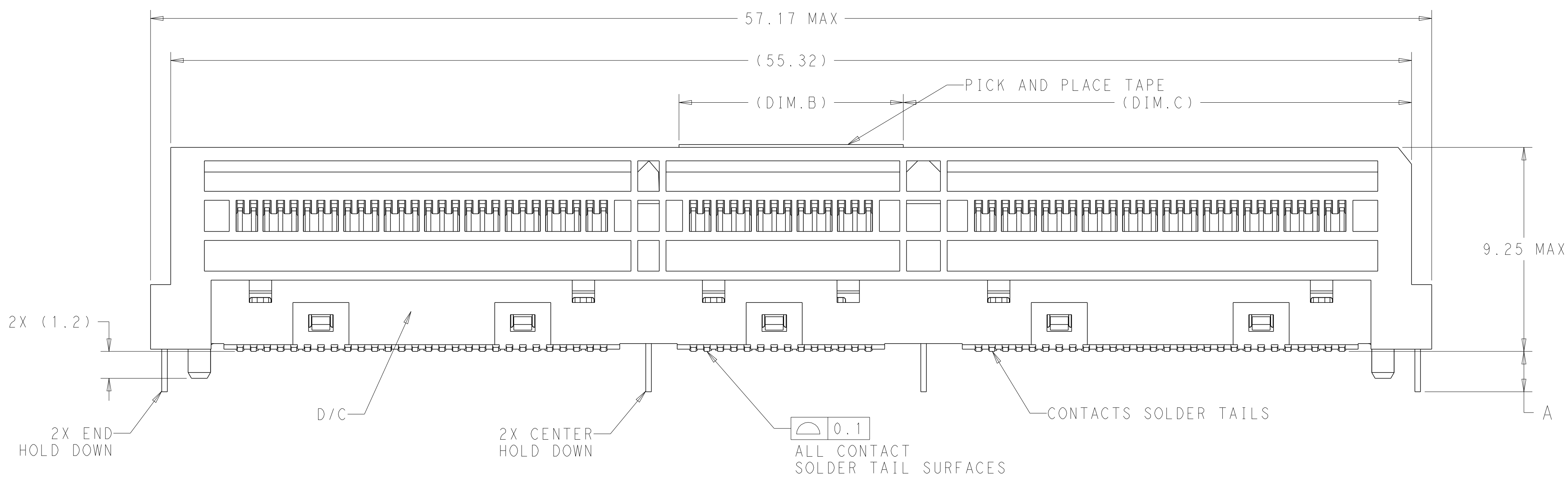
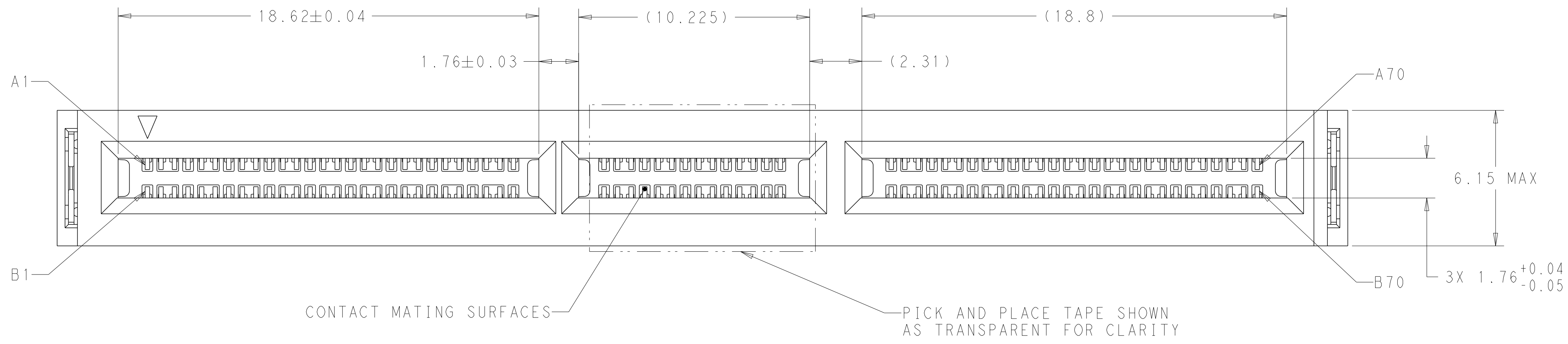
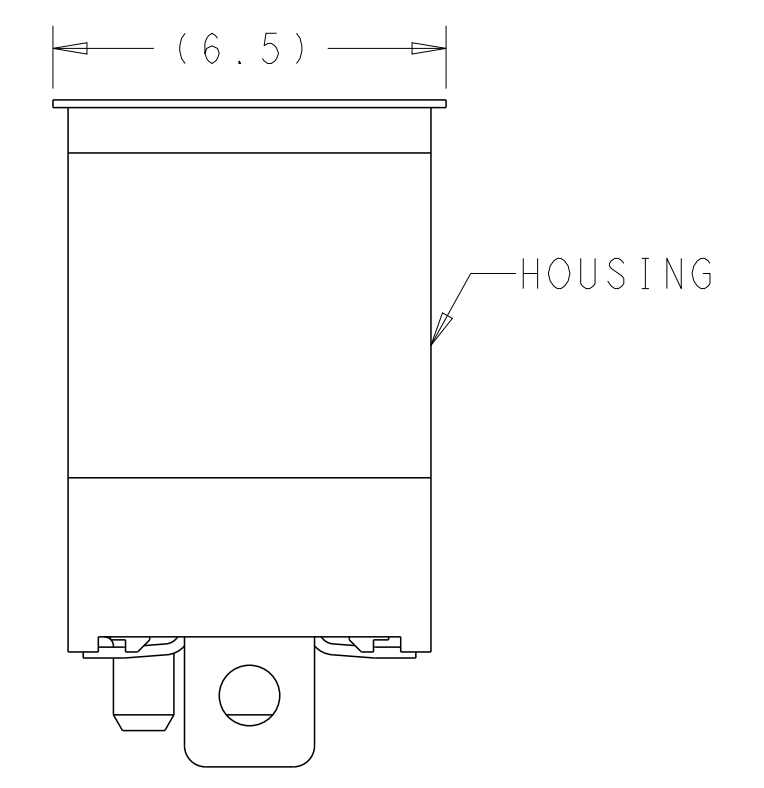

SEE SHEET 4 FOR PART TABLE

| | | | |
|--|--------|-----------------------------|---|
| THIS DRAWING IS A CONTROLLED DOCUMENT. | | OWN: C. VALENTINE 16JAN2018 | TE Connectivity |
| DIMENSIONS: mm | | CHK: D. HARMON 16JAN2018 | |
| TOLERANCES UNLESS OTHERWISE SPECIFIED: | | APVD: D. HARMON 16JAN2018 | NAME: RECEPTACLE ASSEMBLY, VERTICAL, 140 POSITION, SLIVER 2.0 |
| 0 PLC | ± | PRODUCT SPEC | SIZE: CAGE CODE DRAWING NO |
| 1 PLC | ±0.25 | 108-130021 | RESTRICTED TO |
| 2 PLC | ±0.20 | APPLICATION SPEC | A100779C=2327677 |
| 3 PLC | ± | 114-130008 | SCALE 8:1 SHEET 1 OF 4 REV E1 |
| 4 PLC | ± | WEIGHT | |
| ANGLES | ± | CUSTOMER DRAWING | |
| MATERIAL | FINISH | | |

| REVISIONS | | | | |
|-----------|-----|-------------|------|------|
| P | LTN | DESCRIPTION | DATE | APVD |
| - | - | SEE SHEET 1 | - | - |
| | | | | |
| | | | | |

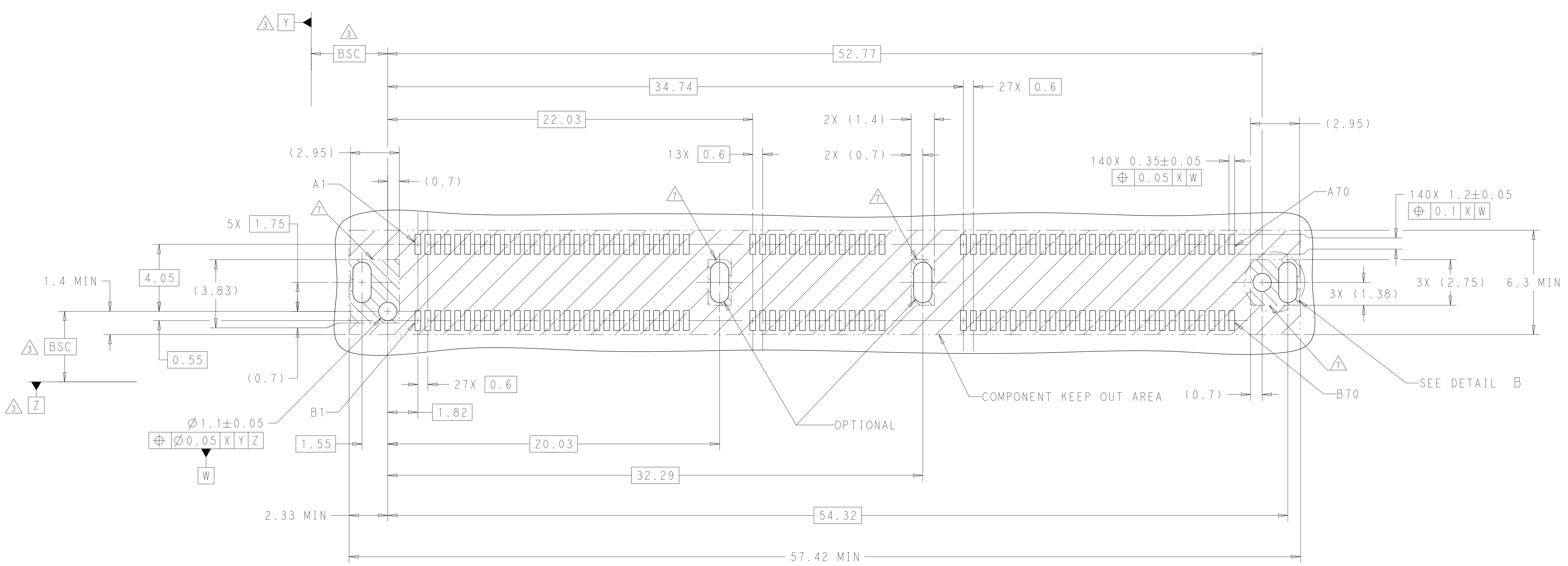

RECOMMENDED PCB LAYOUT
AND KEEP OUT AREA

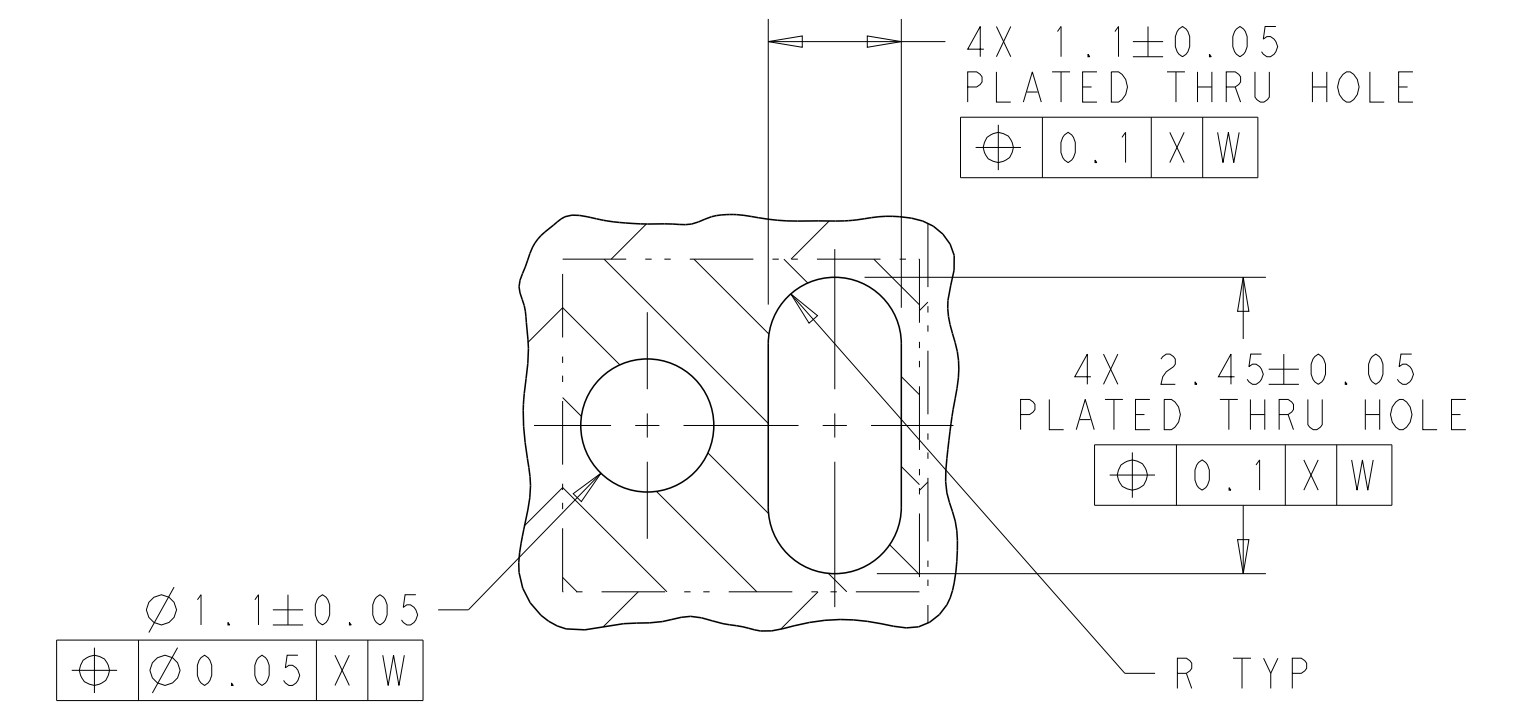
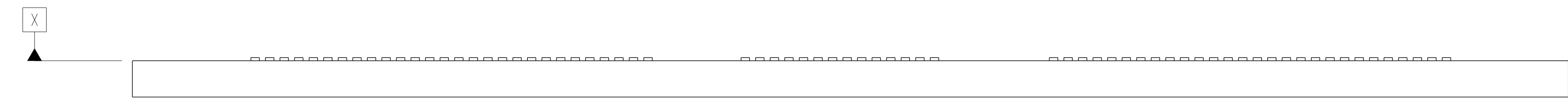

DETAIL B
SCALE 16:1

| | | | |
|--|---|--|--|
| THIS DRAWING IS A CONTROLLED DOCUMENT. | | DWN C. VALENTINE 16JAN2018 CHK D. HARMON 16JAN2018 APVD D. HARMON 16JAN2018 | STE TE Connectivity |
| DIMENSIONS: mm | TOLERANCES UNLESS OTHERWISE SPECIFIED: 0 PLC ± 1 PLC ±0.25 2 PLC ±0.20 3 PLC ± 4 PLC ± ANGLES ± FINISH ± | NAME RECEPTACLE ASSEMBLY, VERTICAL, 140 POSITION, SLIVER 2.0 PRODUCT SPEC 108-130021 APPLICATION SPEC 114-130008 WEIGHT - CUSTOMER DRAWING | SIZE CAGE CODE DRAWING NO RESTRICTED TO A100779C=2327677 SCALE 8:1 SHEET 2 OF 4 REV E1 |

| REVISIONS | | | | |
|-----------|-----|-------------|------|------|
| P | LTN | DESCRIPTION | DATE | APVD |
| - | - | SEE SHEET 1 | - | - |
| | | | | |
| | | | | |

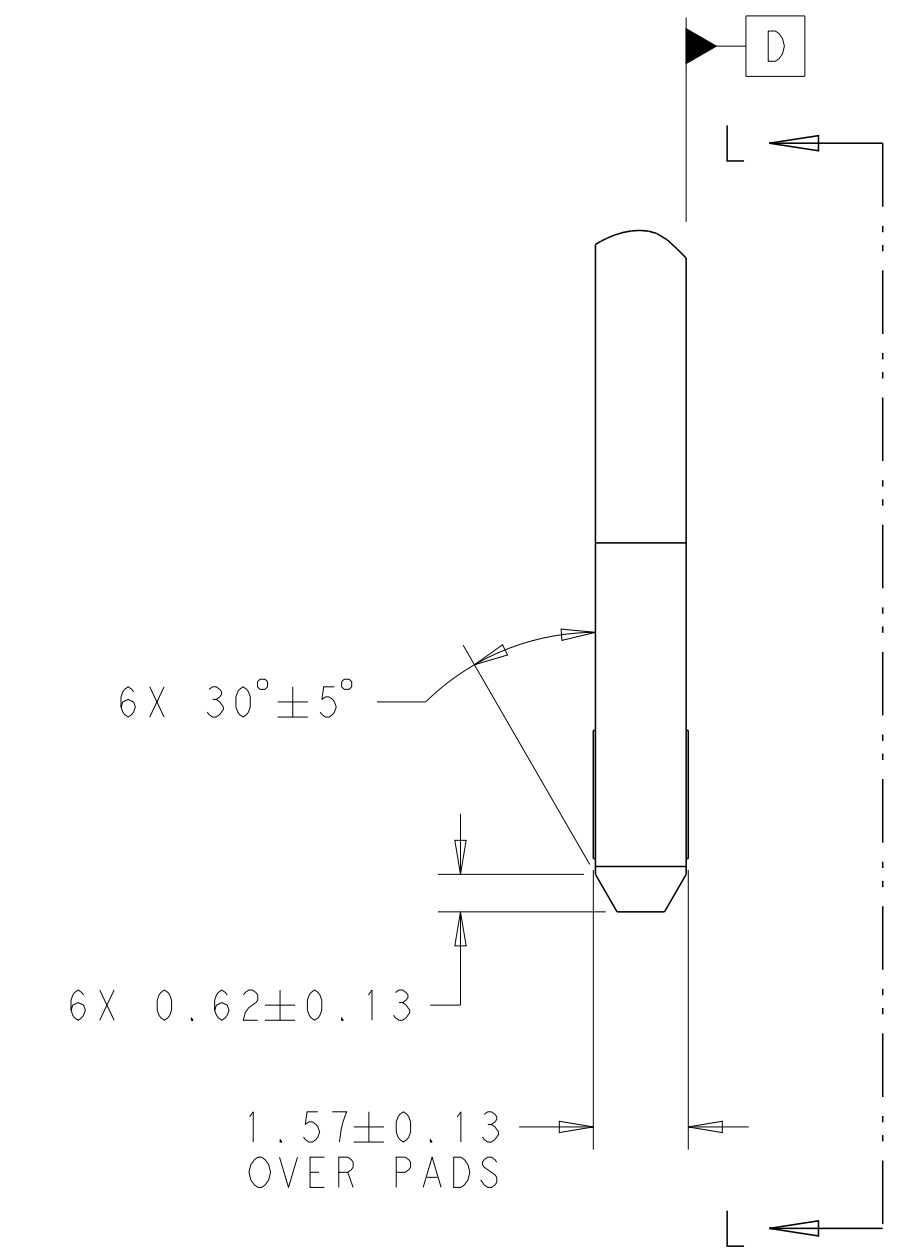
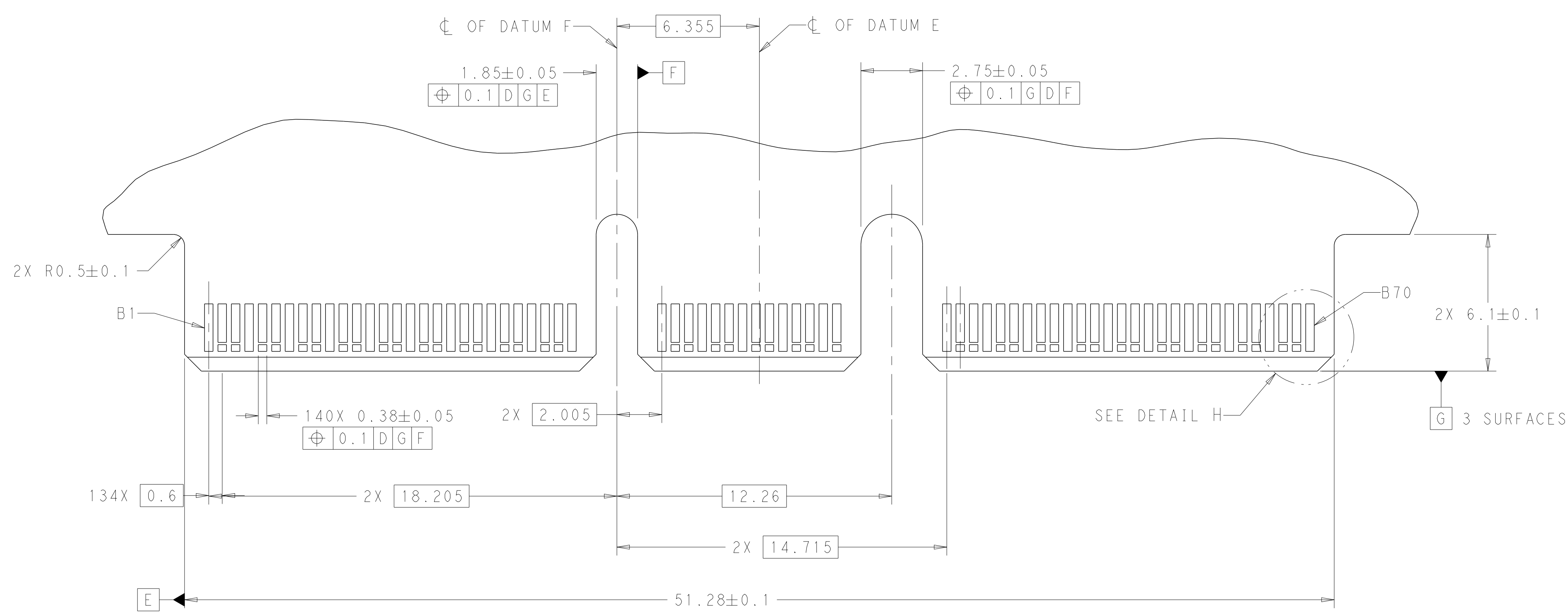

RECOMMENDED PCB OUTLINE DIMENSIONS.
 TOLERANCE VALUES ARE CRITICAL. PLEASE BE SURE TO DESIGNATE
 TOLERANCES TO PCB SUPPLIER TO ENSURE OPTIMIZED FUNCTIONALITY.

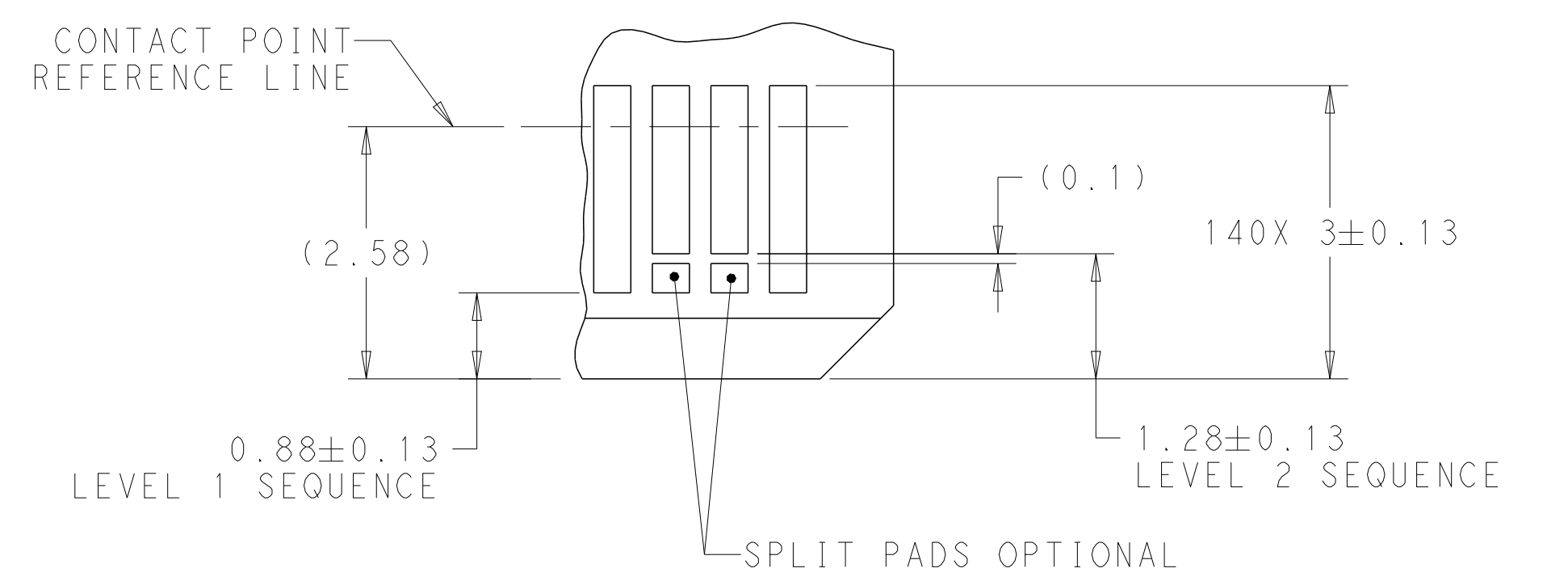
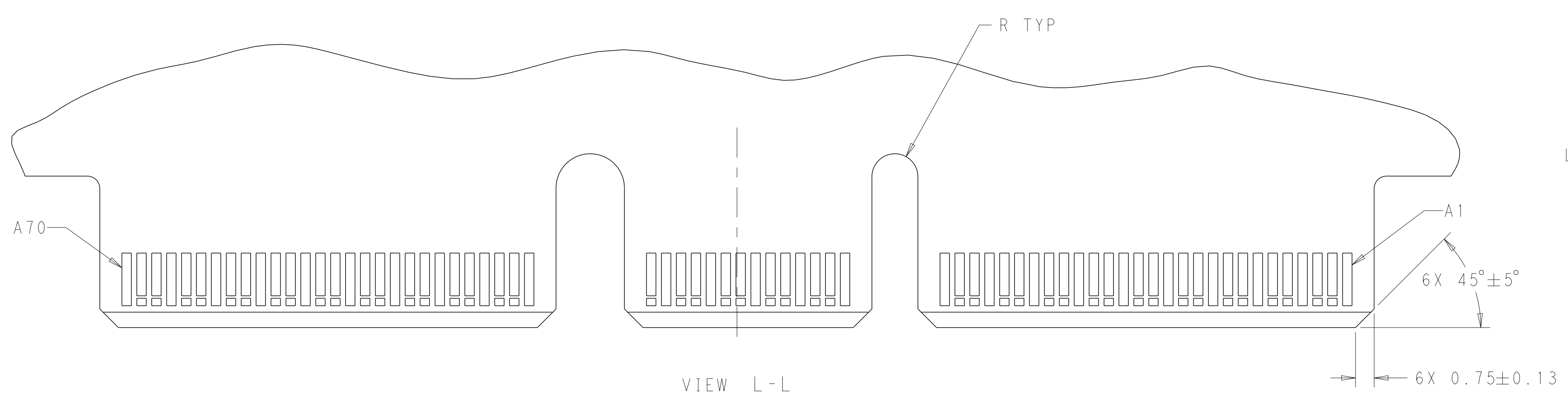

DETAIL H SCALE 16:1

| | | | |
|--|---|--|-----------------|
| THIS DRAWING IS A CONTROLLED DOCUMENT. | | DWN C. VALENTINE 16 JAN 2018 CHK D. HARMON 16 JAN 2018 APVD D. HARMON 16 JAN 2018 | TE Connectivity |
| DIMENSIONS: mm | TOLERANCES UNLESS OTHERWISE SPECIFIED: 0 PLC ± 1 PLC ±0.25 2 PLC ±0.20 3 PLC ± 4 PLC ± ANGLES ± FINISH ± | NAME RECEPTACLE ASSEMBLY, VERTICAL, 140 POSITION, SLIVER 2.0 PRODUCT SPEC 108-130021 APPLICATION SPEC 114-130008 WEIGHT CUSTOMER DRAWING | |

| REVISIONS | | | | |
|-----------|-----|-------------|------|------|
| P | LTN | DESCRIPTION | DATE | APVD |
| - | | SEE SHEET 1 | - | - |
| | | | | |
| | | | | |

TABLE 1: CONNECTOR CONTACT IDENTIFICATION \triangle \triangle \triangle

| CONTACT NUMBER | SIDE A | SIDE B | CONTACT NUMBER | SIDE A | SIDE B |
|----------------|--------|--------|----------------|--------|--------|
| 1 | GROUND | GROUND | 36 | SIGNAL | SIGNAL |
| 2 | SIGNAL | SIGNAL | 37 | SIGNAL | SIGNAL |
| 3 | SIGNAL | SIGNAL | 38 | GROUND | GROUND |
| 4 | GROUND | GROUND | 39 | SIGNAL | SIGNAL |
| 5 | SIGNAL | SIGNAL | 40 | SIGNAL | SIGNAL |
| 6 | SIGNAL | SIGNAL | 41 | GROUND | GROUND |
| 7 | GROUND | GROUND | 42 | GROUND | GROUND |
| 8 | SIGNAL | SIGNAL | 43 | GROUND | GROUND |
| 9 | SIGNAL | SIGNAL | 44 | SIGNAL | SIGNAL |
| 10 | GROUND | GROUND | 45 | SIGNAL | SIGNAL |
| 11 | SIGNAL | SIGNAL | 46 | GROUND | GROUND |
| 12 | SIGNAL | SIGNAL | 47 | SIGNAL | SIGNAL |
| 13 | GROUND | GROUND | 48 | SIGNAL | SIGNAL |
| 14 | SIGNAL | SIGNAL | 49 | GROUND | GROUND |
| 15 | SIGNAL | SIGNAL | 50 | SIGNAL | SIGNAL |
| 16 | GROUND | GROUND | 51 | SIGNAL | SIGNAL |
| 17 | SIGNAL | SIGNAL | 52 | GROUND | GROUND |
| 18 | SIGNAL | SIGNAL | 53 | SIGNAL | SIGNAL |
| 19 | GROUND | GROUND | 54 | SIGNAL | SIGNAL |
| 20 | SIGNAL | SIGNAL | 55 | GROUND | GROUND |
| 21 | SIGNAL | SIGNAL | 56 | SIGNAL | SIGNAL |
| 22 | GROUND | GROUND | 57 | SIGNAL | SIGNAL |
| 23 | SIGNAL | SIGNAL | 58 | GROUND | GROUND |
| 24 | SIGNAL | SIGNAL | 59 | SIGNAL | SIGNAL |
| 25 | GROUND | GROUND | 60 | SIGNAL | SIGNAL |
| 26 | SIGNAL | SIGNAL | 61 | GROUND | GROUND |
| 27 | SIGNAL | SIGNAL | 62 | SIGNAL | SIGNAL |
| 28 | GROUND | GROUND | 63 | SIGNAL | SIGNAL |
| 29 | GROUND | GROUND | 64 | GROUND | GROUND |
| 30 | SIGNAL | SIGNAL | 65 | SIGNAL | SIGNAL |
| 31 | SIGNAL | SIGNAL | 66 | SIGNAL | SIGNAL |
| 32 | GROUND | GROUND | 67 | GROUND | GROUND |
| 33 | SIGNAL | SIGNAL | 68 | SIGNAL | SIGNAL |
| 34 | SIGNAL | SIGNAL | 69 | SIGNAL | SIGNAL |
| 35 | GROUND | GROUND | 70 | GROUND | GROUND |

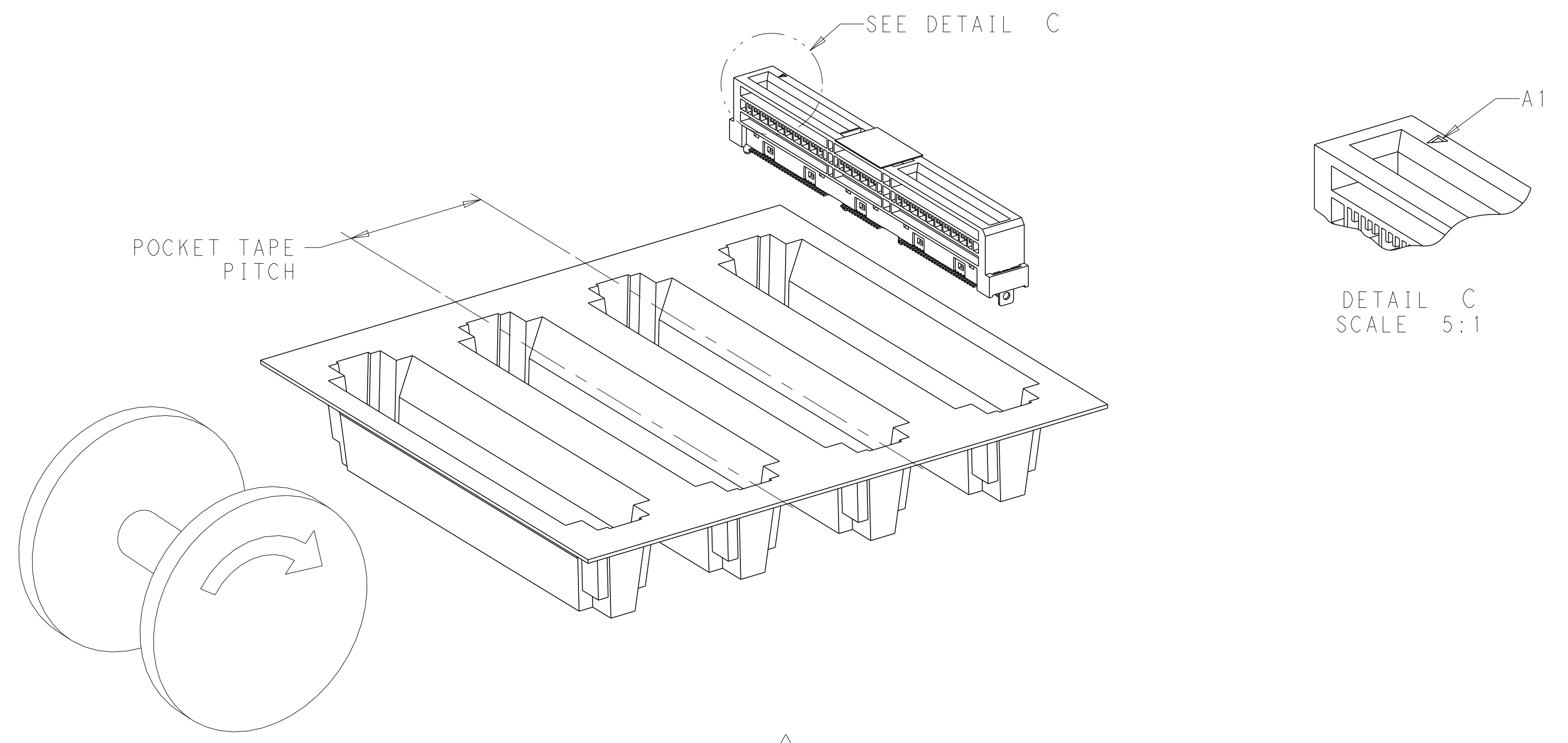

FIGURE 1 \triangle
 DIRECTION OFF TOP OF REEL
 FOR USER UNREELING
 SHOWN AS 2327677-1 THRU 2-2327677-3, 3-2327677-3
 SCALE 2:1

| | | | | | | | | | |
|-------|-------|---------|------------|---------------|-------------------|---------------|---------------------|---------------|-------------|
| 22.66 | 10 | 1.8±0.1 | ALL | 0.76µm Au | 20 | 350 | YES | 200 | 3-2327677-3 |
| 7.66 | 40 | 1.8±0.1 | ALL | 0.76µm Au | 20 | 350 | YES | 200 | 5-2327677-3 |
| 22.66 | 10 | 3±0.1 | ALL | 0.76µm Au | 20 | 250 | YES | 200 | 2-2327677-3 |
| N/A | N/A | 1.2±0.1 | ENDS | 0.76µm Au | 24 | 250 | NO | 200 | 1-2327677-9 |
| | | | | 0.38µm Au | | | | 100 | 1-2327677-8 |
| | | | | FLASH Au/PdNi | | | | 50 | 1-2327677-7 |
| N/A | N/A | 1.8±0.1 | ENDS | 0.76µm Au | 24 | 250 | NO | 200 | 1-2327677-6 |
| | | | | 0.38µm Au | | | | 100 | 1-2327677-5 |
| | | | | FLASH Au/PdNi | | | | 50 | 1-2327677-4 |
| N/A | N/A | 1.8±0.1 | ALL | 0.76µm Au | 24 | 250 | NO | 200 | 1-2327677-3 |
| | | | | 0.38µm Au | | | | 100 | 1-2327677-2 |
| | | | | FLASH Au/PdNi | | | | 50 | 1-2327677-1 |
| 22.66 | 10 | 1.2±0.1 | ENDS | 0.76µm Au | 20 | 350 | YES | 200 | 2327677-9 |
| | | | | 0.38µm Au | | | | 100 | 2327677-8 |
| | | | | FLASH Au/PdNi | | | | 50 | 2327677-7 |
| 22.66 | 10 | 1.8±0.1 | ENDS | 0.76µm Au | 20 | 350 | YES | 200 | 2327677-6 |
| | | | | 0.38µm Au | | | | 100 | 2327677-5 |
| | | | | FLASH Au/PdNi | | | | 50 | 2327677-4 |
| 22.66 | 10 | 1.8±0.1 | ALL | 0.76µm Au | 20 | 350 | YES | 200 | 2327677-3 |
| | | | | 0.38µm Au | | | | 100 | 2327677-2 |
| | | | | FLASH Au/PdNi | | | | 50 | 2327677-1 |
| DIM.C | DIM.B | A | HOLD DOWNS | PLATING | POCKET TAPE PITCH | REEL QUANTITY | PICK AND PLACE TAPE | MATING CYCLES | PART NUMBER |

THIS DRAWING IS A CONTROLLED DOCUMENT.

APVD: D. HARMON 16 JAN 2018
 CHK: D. HARMON 16 JAN 2018
 DWN: C. VALENTINE 16 JAN 2018

RECEPTACLE ASSEMBLY, VERTICAL, 140 POSITION, SLIVER 2.0

SCALE 8:1 SHEET 4 OF 4 REV E1