

SCL SERIES HEAT SHRINK TUBING

SCL is constructed as a dual-wall tubing. The outer wall is a semi-rigid, crosslinked polyolefin, while the inner wall is a meltable polyolefin that flows with the application of heat. Heating SCL shrinks the outer jacket and melts the inner “encapsulant” wall to flow and fill surface irregularities. While still hot, the tubing can be pinched and blocked to form a wire breakout. SCL provides a splash-resistant, moisture-resistant covering suitable for many applications. SCL also performs satisfactorily if briefly exposed to common solvents or chemicals. The installed tubing provides rugged protection against abrasion, vibration, and flexing.

The MIL-Spec versions of these products are temporarily unavailable, but we have equivalent, non-MIL-Spec parts available that can be ordered.

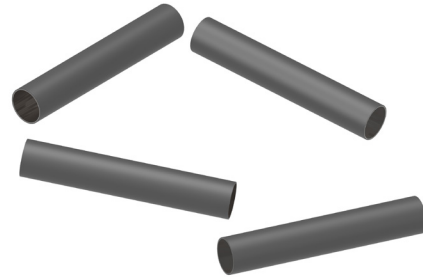

Part No	Part Description	New Non-MIL Spec. Part No.	New Non-MIL Spec. Part Description
NB25882001	SCL-1/2-0-STK	NB46232001	SCL-1/2-0-STK-CS34568
NB25912001	SCL-1/2-2-STK	NB46132001	SCL-1/2-2-STK-CS34568
NB25962001	SCL-1/4-0-STK	NB46242001	SCL-1/4-0-STK-CS34568
NB25992001	SCL-1/4-2-STK	NB46112001	SCL-1/4-2-STK-CS34568
NB25822001	SCL-1/8-0-STK	NB46072001	SCL-1/8-0-STK-CS34568
NB26072001	SCL-1/8-2-STK	NB46082001	SCL-1/8-2-STK-CS34568
NB25862001	SCL-3/16-0-STK	NB46092001	SCL-3/16-0-STK-CS34568
NB25902001	SCL-3/16-2-STK	NB46102001	SCL-3/16-2-STK-CS34568
NB25922001	SCL-3/4-0-STK	NB46152001	SCL-3/4-0-STK-CS34568
NB25752001	SCL-3/4-2-STK	NB46142001	SCL-3/4-2-STK-CS34568
NB25842001	SCL-3/8-0-STK	NB46282001	SCL-3/8-0-STK-CS34568
NB25802001	SCL-3/8-2-STK	NB46122001	SCL-3/8-2-STK-CS34568

Connect With Us

We make it easy to connect with our experts and are ready to provide all the support you need. Visit te.com/support to chat with a Product Information Specialist.

te.com

TE, TE Connectivity, TE connectivity (logo), and EVERY CONNECTION COUNTS are trademarks owned or licensed by the TE Connectivity Ltd. family of companies. Other product names, logos, and company names mentioned herein may be trademarks of their respective owners.

The information given herein, including drawings, illustrations and schematics which are intended for illustration purposes only, is believed to be reliable. However, TE Connectivity makes no warranties as to its accuracy or completeness and disclaims any liability in connection with its use. TE Connectivity's obligations shall only be as set forth in TE Connectivity's Standard Terms and Conditions of Sale for this product and in no case will TE Connectivity be liable for any incidental, indirect or consequential damages arising out of the sale, resale, use or misuse of the product. Users of TE Connectivity products should make their own evaluation to determine the suitability of each such product for the specific application.

©2024 TE Connectivity. All Rights Reserved.

08-24